

1 INTERIOR ELEVATION

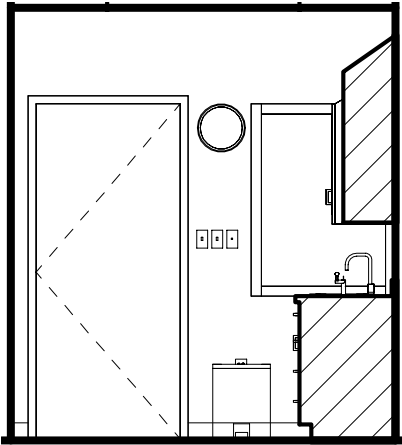

2 INTERIOR ELEVATION

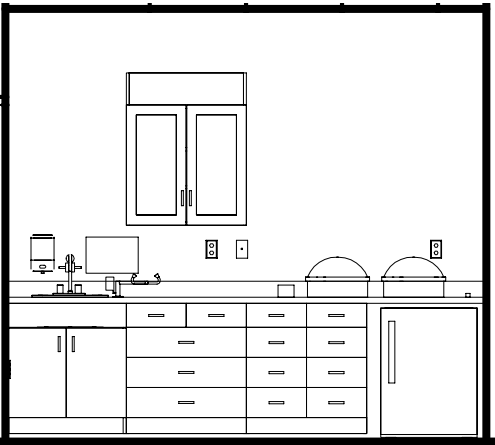

3 INTERIOR ELEVATION

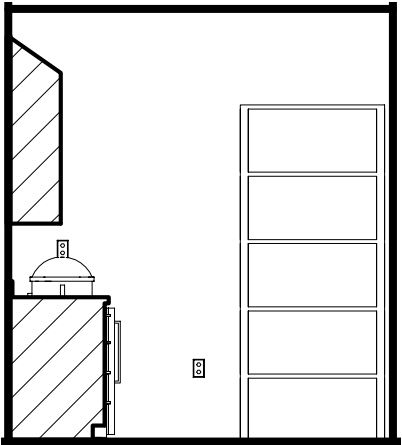

4 INTERIOR ELEVATION

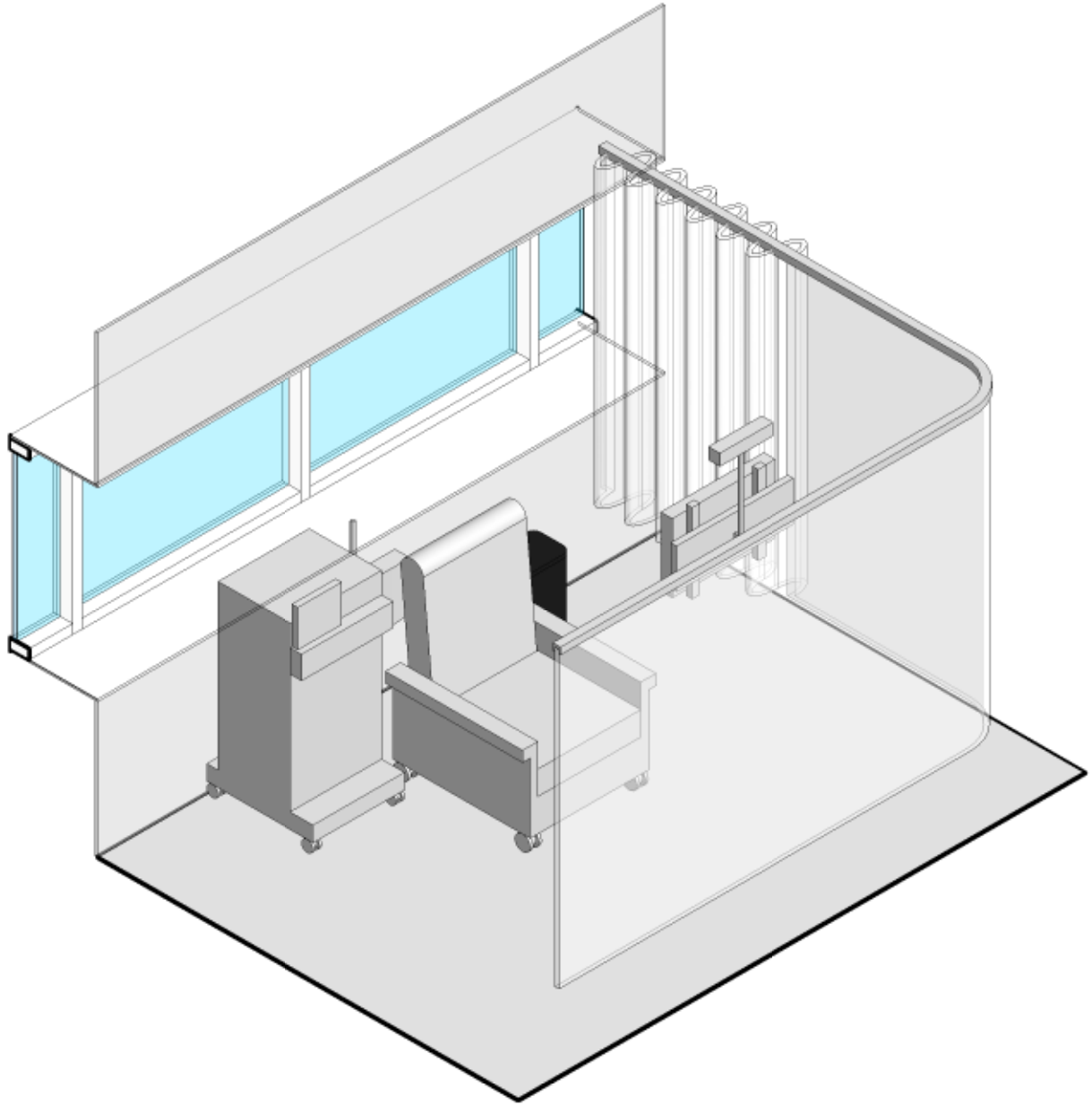

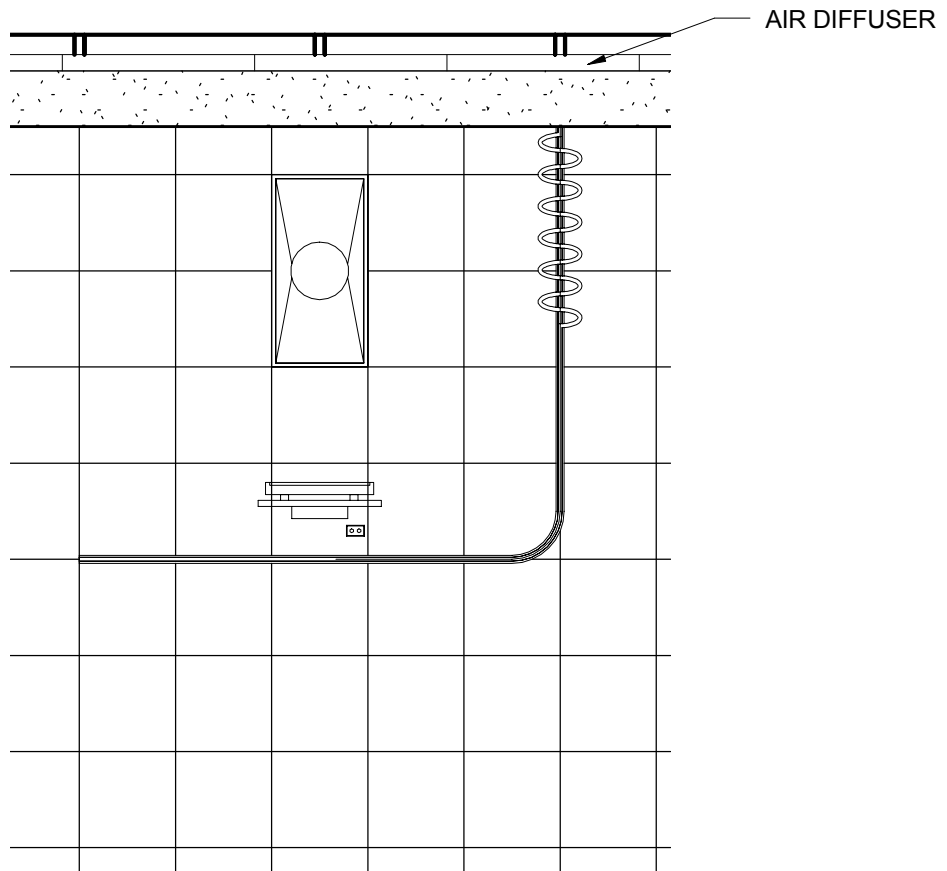

FGI GUIDELINES:

1. Individual patient treatment areas shall contain at least 80 square feet (7.43 Square meters).
2. There shall be a clear dimension of at least 4 feet (1.22 meters) between dialysis chairs.
3. The open unit shall be designed to provide privacy for each patient.

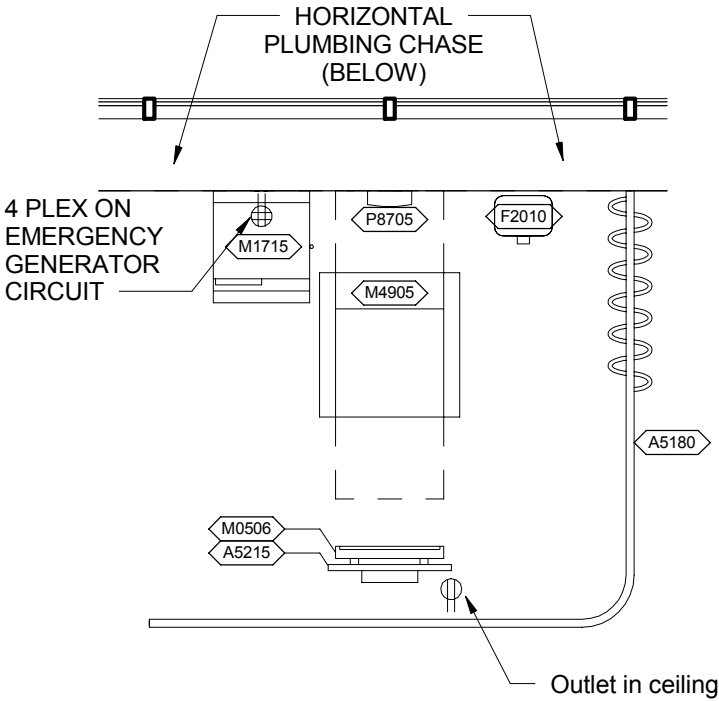

| JSN | Nomenclature | Qty | Log Cat | Util1 | Util2 | Util3 | Util4 | Util5 | Util6 |
|-------|---|-----|---------|-------|-------|-------|-------|-------|-------|
| A5077 | Dispenser, Hand Sanitizer, Hands free | 1 | C | - | - | - | - | - | - |
| A5106 | Waste Disposal Unit, Sharps w/Glove Dispenser | 1 | C | - | - | - | - | - | - |
| A5180 | Track, Cubicle, Surface Mounted, With Curtain | 1 | A | - | - | - | - | - | - |
| A5215 | Bracket, Television, Ceiling Mounted | 1 | B | - | - | - | - | - | - |
| F2010 | Basket, Wastepaper, Step-On | 1 | C | - | - | - | - | - | - |
| M0506 | Television, Flat Screen | 1 | C | - | A | - | - | - | - |
| M1715 | Hemodialysis Unit, Hollow Fiber or Plate | 1 | C | E | A | - | - | - | - |
| M4905 | Chair, Dialysis | 1 | C | - | - | - | - | - | - |
| P8705 | Dialysis Box, Recessed, Single Valve | 1 | A | B | - | - | - | - | - |

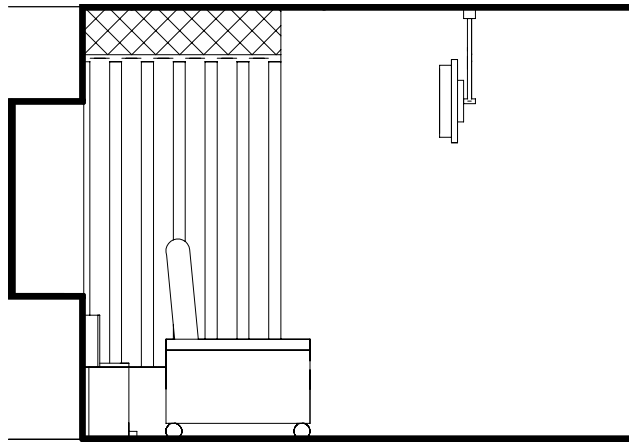

1

INTERIOR ELEVATION

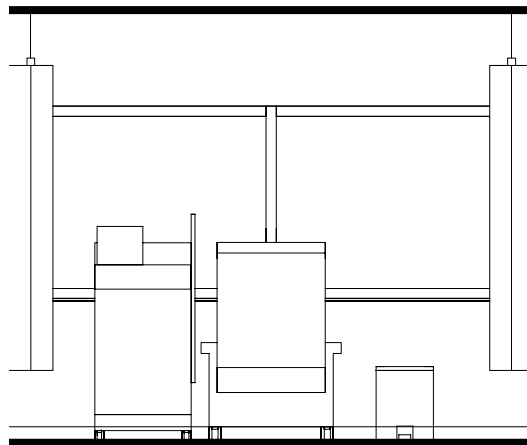

2

INTERIOR ELEVATION

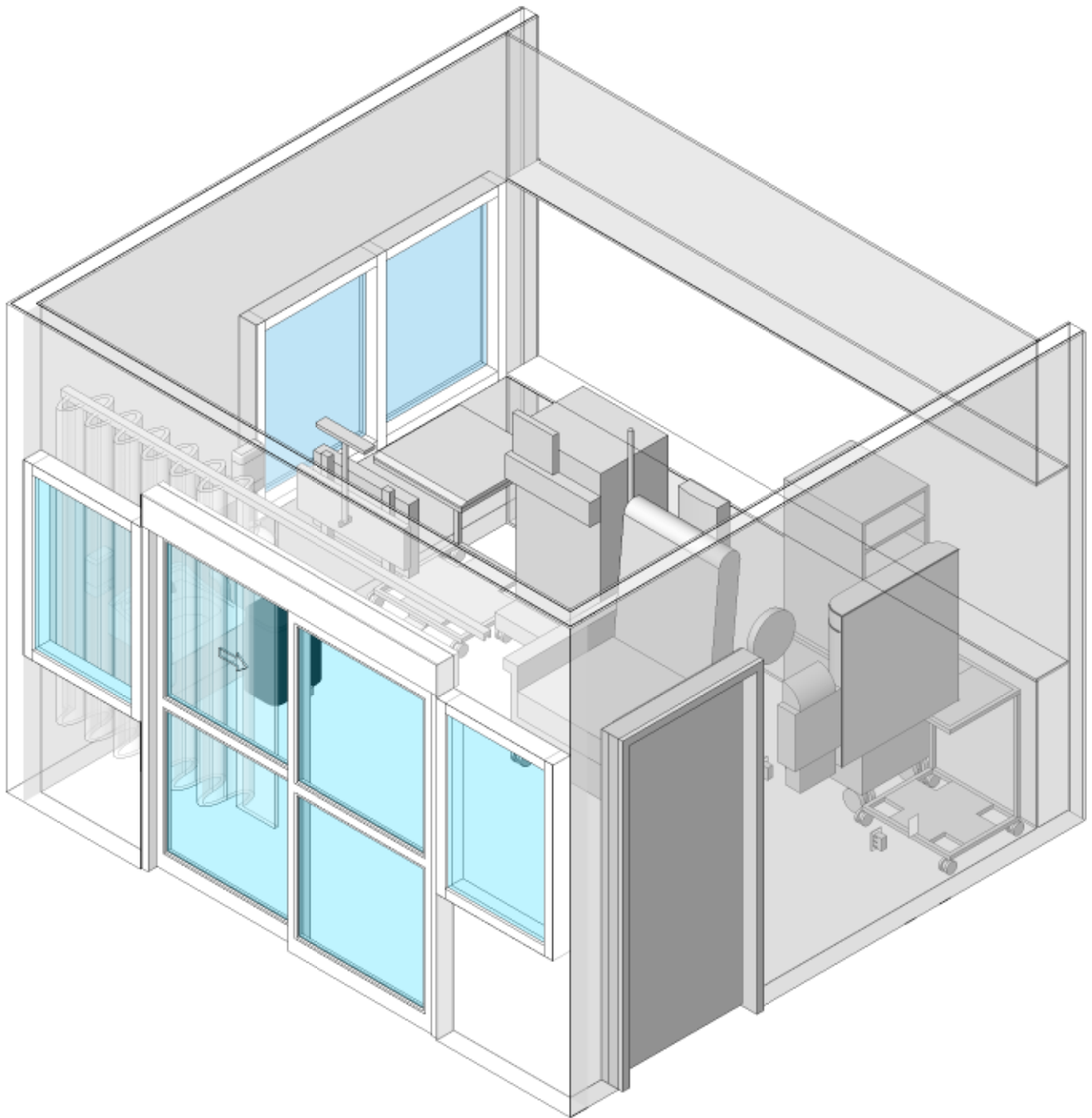

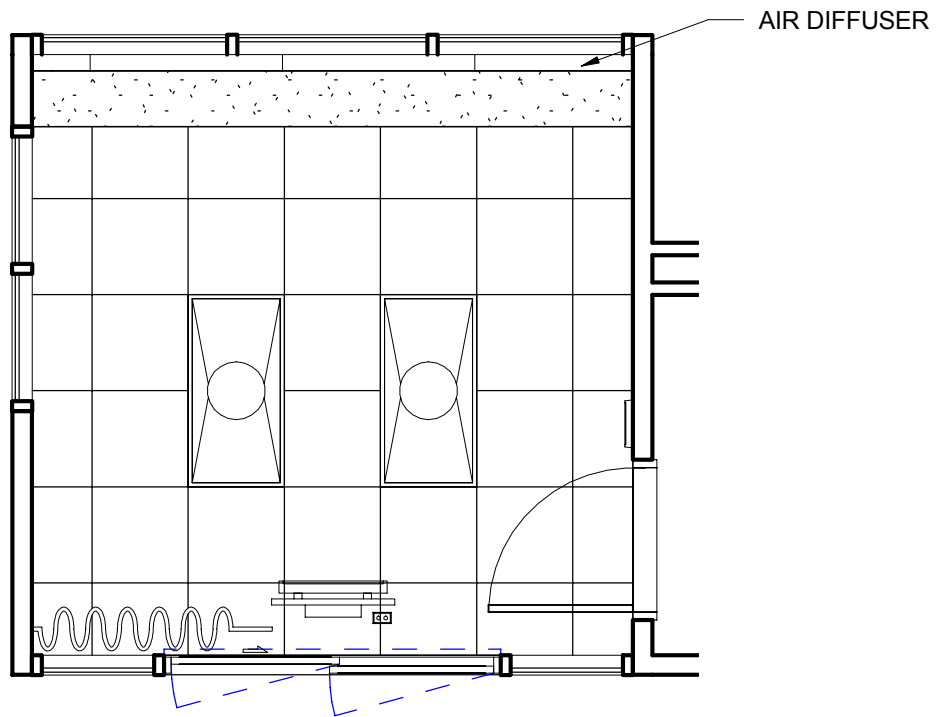

FGI GUIDELINES:

1. Space shall be provided for a private room for hemodialysis patients who are hepatitis B antigen-positive.
2. Facilities that hemodialyze patients who are hepatitis B surface antigen-positive shall have at least one separate area with walls that have a minimum height of five feet for hemodialysis treatment of those patients.
3. This space shall be flexible to accommodate a stretcher.
3. The separation area shall allow for direct observation of the patient by staff during treatment via a sliding glass door.
5. This room may accommodate a patient who becomes agitated or causes anxiety for other patients.
6. The separation area shall contain a hand-washing station.

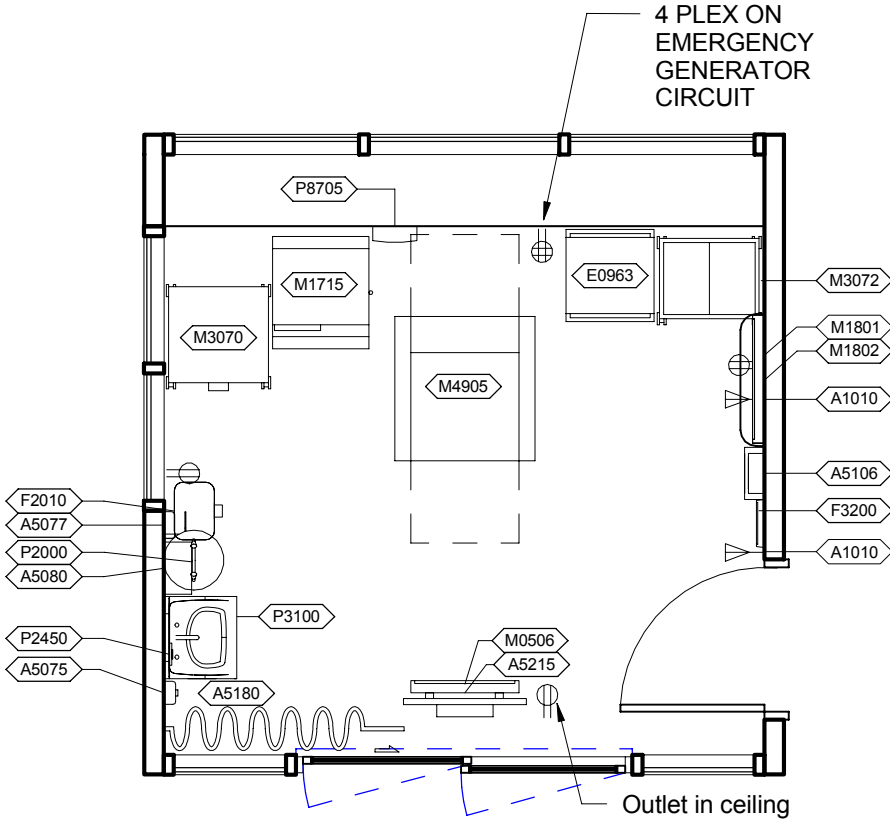

| JSN | Nomenclature | Qty | Log Cat | Util1 | Util2 | Util3 | Util4 | Util5 | Util6 |
|-------|---|-----|---------|-------|-------|-------|-------|-------|-------|
| A1010 | Telecommunication Outlet | 2 | A | | | | | | |
| A5075 | Dispenser, Soap, Disposable | 1 | C | - | - | - | - | - | - |
| A5077 | Dispenser, Hand Sanitizer, Hands free | 1 | C | - | - | - | - | - | - |
| A5080 | Dispenser, Paper Towel, SS Surface Mounted | 1 | A | - | - | - | - | - | - |
| A5106 | Waste Disposal Unit, Sharps w/Glove Dispenser | 1 | C | - | - | - | - | - | - |
| A5180 | Track, Cubicle, Surface Mounted, With Curtain | 1 | A | - | - | - | - | - | - |
| A5215 | Bracket, Television, Ceiling Mounted | 1 | B | - | - | - | - | - | - |
| E0963 | Cart, General Storage, Mobile | 1 | C | - | - | - | - | - | - |
| F2010 | Basket, Wastepaper, Step-On | 1 | C | - | - | - | - | - | - |
| F3200 | Clock, Battery, 12" Diameter | 1 | C | - | - | - | - | - | - |
| M0506 | Television, Flat Screen | 1 | C | - | A | - | - | - | - |
| M1715 | Hemodialysis Unit, Hollow Fiber or Plate | 1 | C | E | A | - | - | - | - |
| M1801 | Computer, Microprocessing, w/Flat Panel Monitor | 1 | C | - | A | - | - | - | - |
| M1802 | Work Station, Computer, Retractable, Wall Mounted | 1 | C | - | - | - | - | - | - |
| M3070 | Hamper, Linen, Mobile, w/Lid | 1 | C | - | - | - | - | - | - |
| M3072 | Frame, Infectious Waste Bag w/Lid | 1 | C | - | - | - | - | - | - |
| M4905 | Chair, Dialysis | 1 | C | - | - | - | - | - | - |
| P2000 | Eyewash, Wall Mounted, Hands-Free | 1 | A | A | B | - | - | - | - |
| P2450 | Valve, Mixing, Thermostatic | 1 | A | A | - | - | - | - | - |
| P3100 | Lavatory, Vitreous China, Slab Type | 1 | A | D | - | - | - | - | - |
| P8705 | Dialysis Box, Recessed, Single Valve | 1 | A | B | - | - | - | - | - |

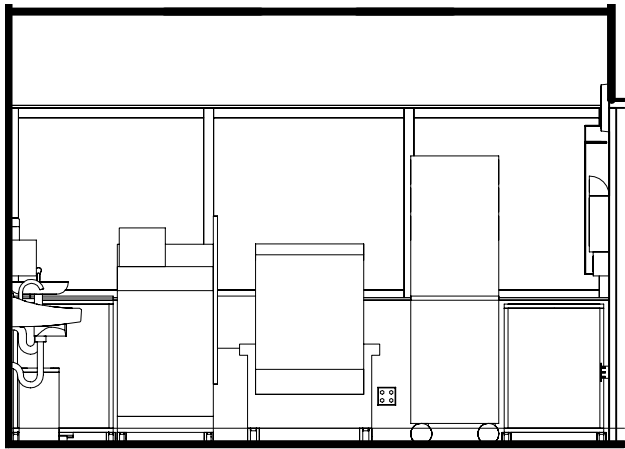

1 INTERIOR ELEVATION

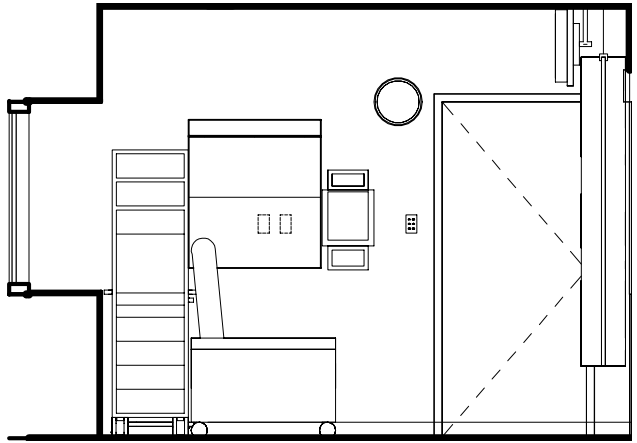

2 INTERIOR ELEVATION

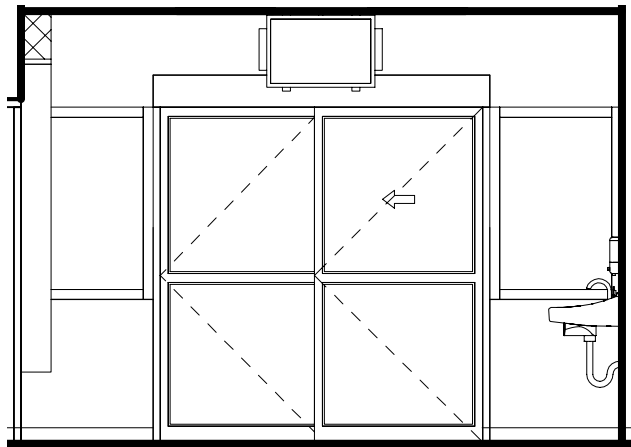

3 INTERIOR ELEVATION

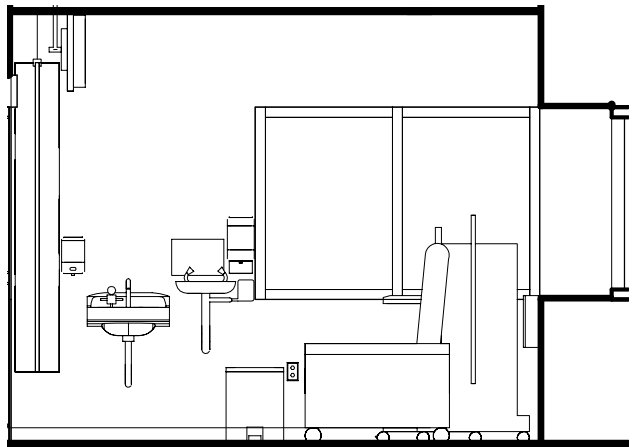

4 INTERIOR ELEVATION

Sheet

Description: RENAL DIALYSIS SEPARATION STATION ELEVATIONS (RDC02)

Scale: 1/4" = 1'-0"

Sheet: 4D

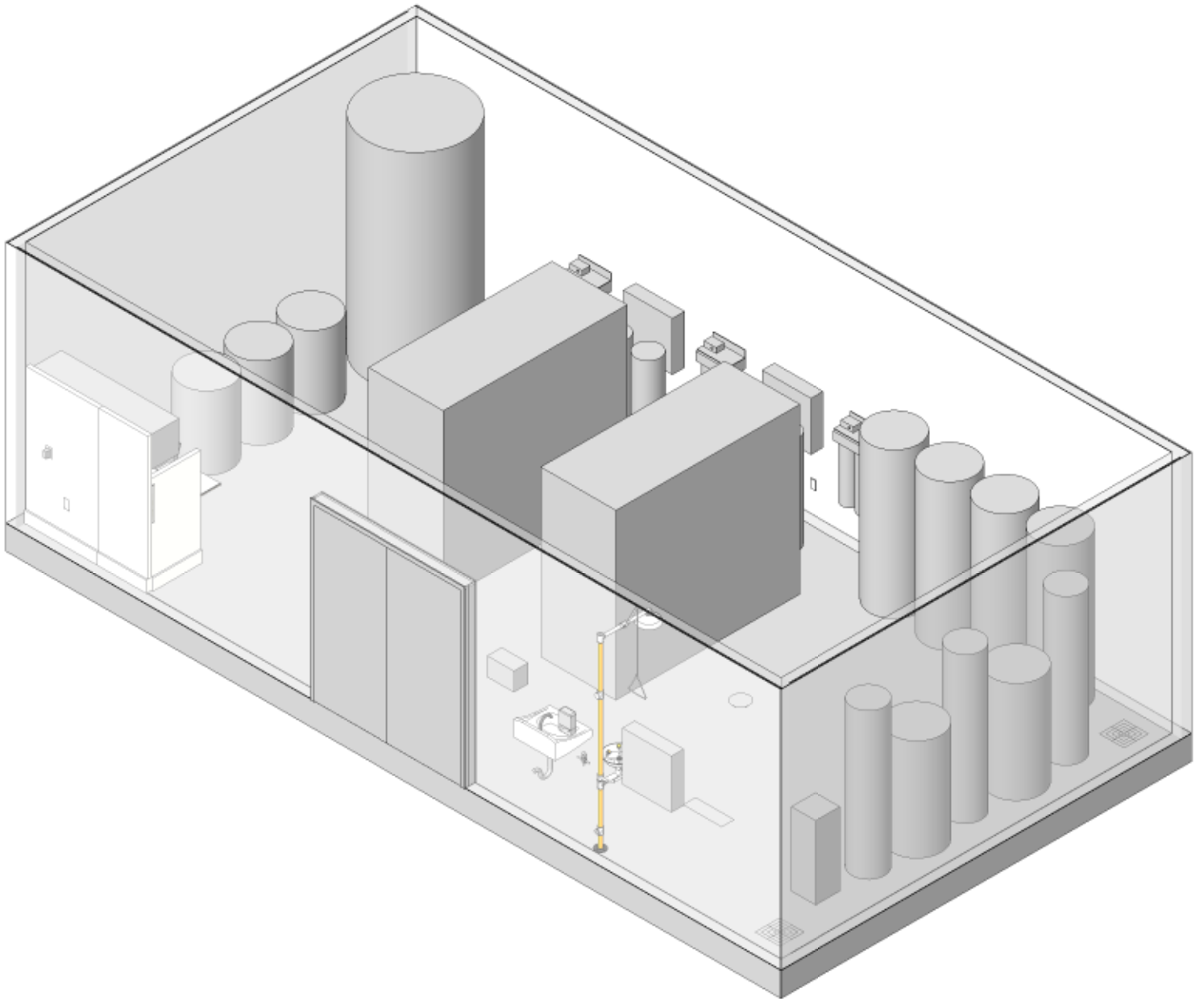

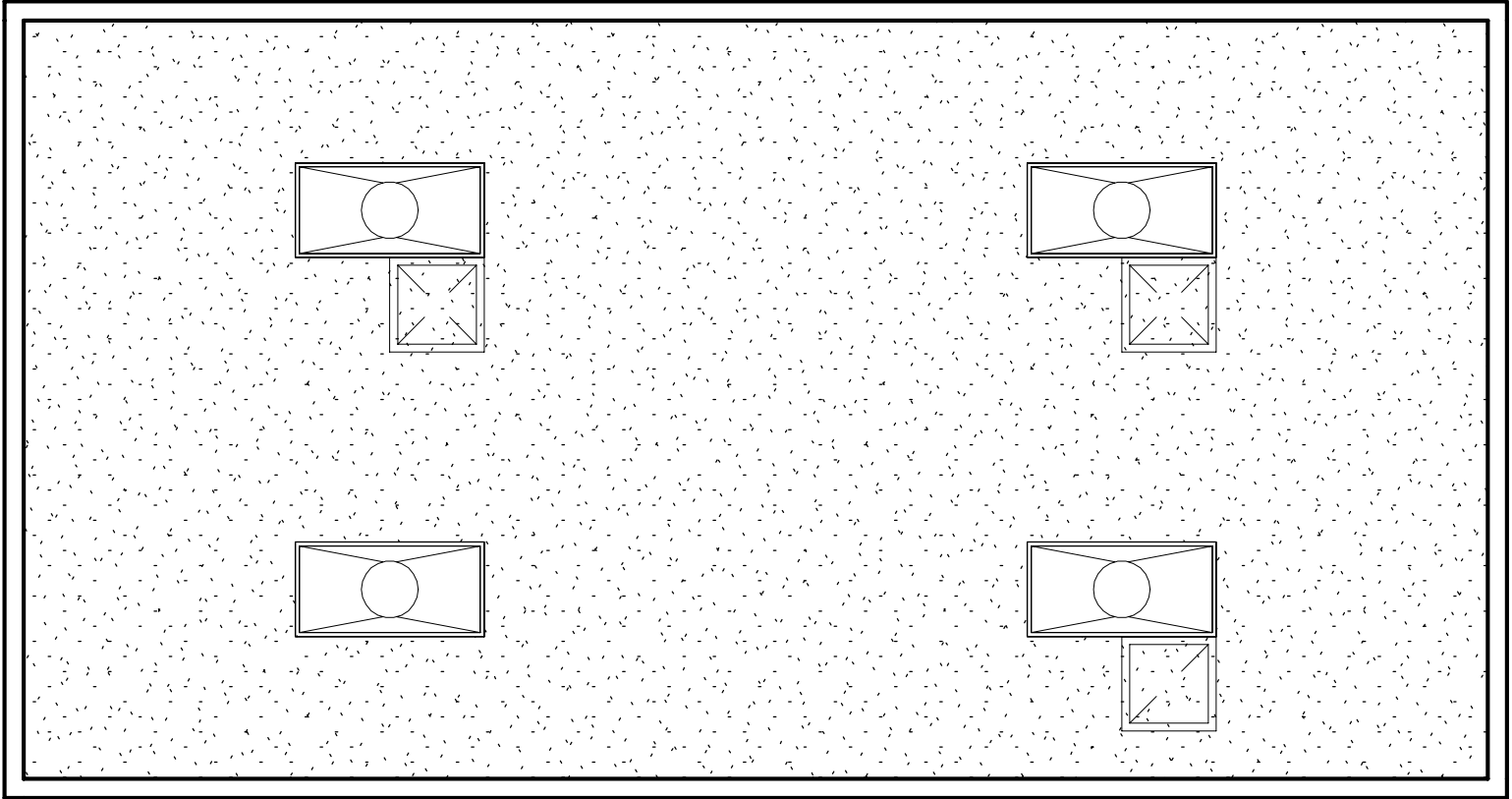

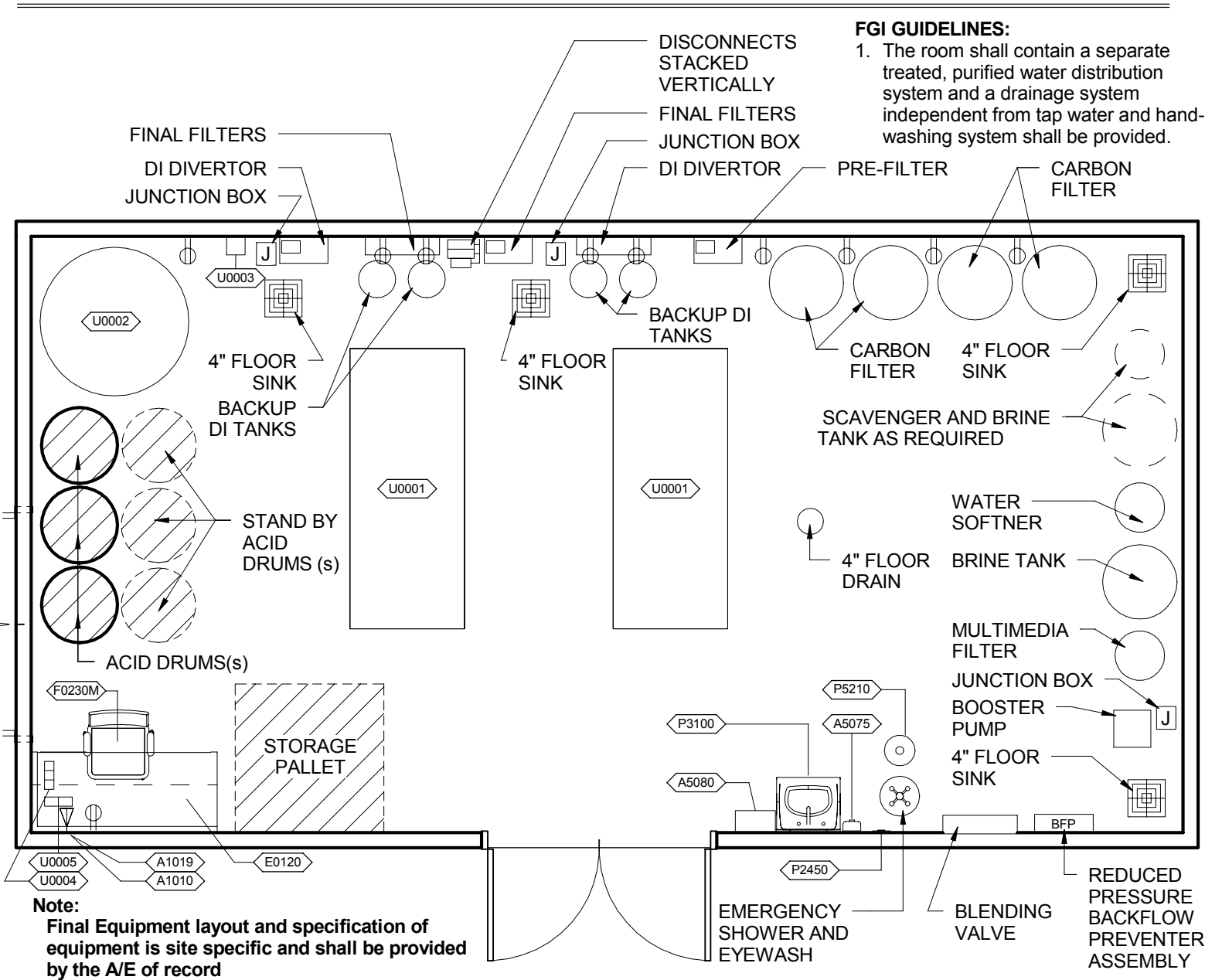

FGI GUIDELINES:
 1. The room shall contain a separate treated, purified water distribution system and a drainage system independent from tap water and hand-washing system shall be provided.

Note:
 Final Equipment layout and specification of equipment is site specific and shall be provided by the A/E of record

| JSN | Nomenclature | Qty | Log Cat | Util1 | Util2 | Util3 | Util4 | Util5 | Util6 |
|--------|--|-----|---------|-------|-------|-------|-------|-------|-------|
| A1010 | Telecommunication Outlet | 1 | A | | | | | | |
| A1019 | Telephone, Wall Mounted, Multi-Line, Cordless | 1 | A | | | | | | |
| A5075 | Dispenser, Soap, Disposable | 1 | C | - | - | - | - | - | - |
| A5080 | Dispenser, Paper Towel, SS Surface Mounted | 1 | A | - | - | - | - | - | - |
| E0120 | Workstation, Straight, Free Standing, 60" W | 1 | A | - | - | - | - | - | - |
| F0230M | Chair, Drafting, Rotary | 1 | C | - | - | - | - | - | - |
| P2450 | Valve, Mixing, Thermostatic | 1 | A | A | - | - | - | - | - |
| P3100 | Lavatory, Vitreous China, Slab Type | 1 | A | D | - | - | - | - | - |
| P5210 | Shower, Safety, Freestanding, With Eye/Face Wash | 1 | C | | | | | | |
| U0001 | Direct Feed, RO Water | 2 | C | D | G | - | - | - | - |
| U0002 | Distribution System, Acid | 1 | C | - | A | - | - | - | - |
| U0003 | Pump, Drum / Barrel | 1 | - | - | A | - | - | - | - |
| U0004 | Meter, Chlorine, Battery Powered, Kit | 3 | C | - | - | - | - | - | - |
| U0005 | Meter, Water Quality, Multi Paramters, Battery Powered | 2 | C | - | - | - | - | - | - |

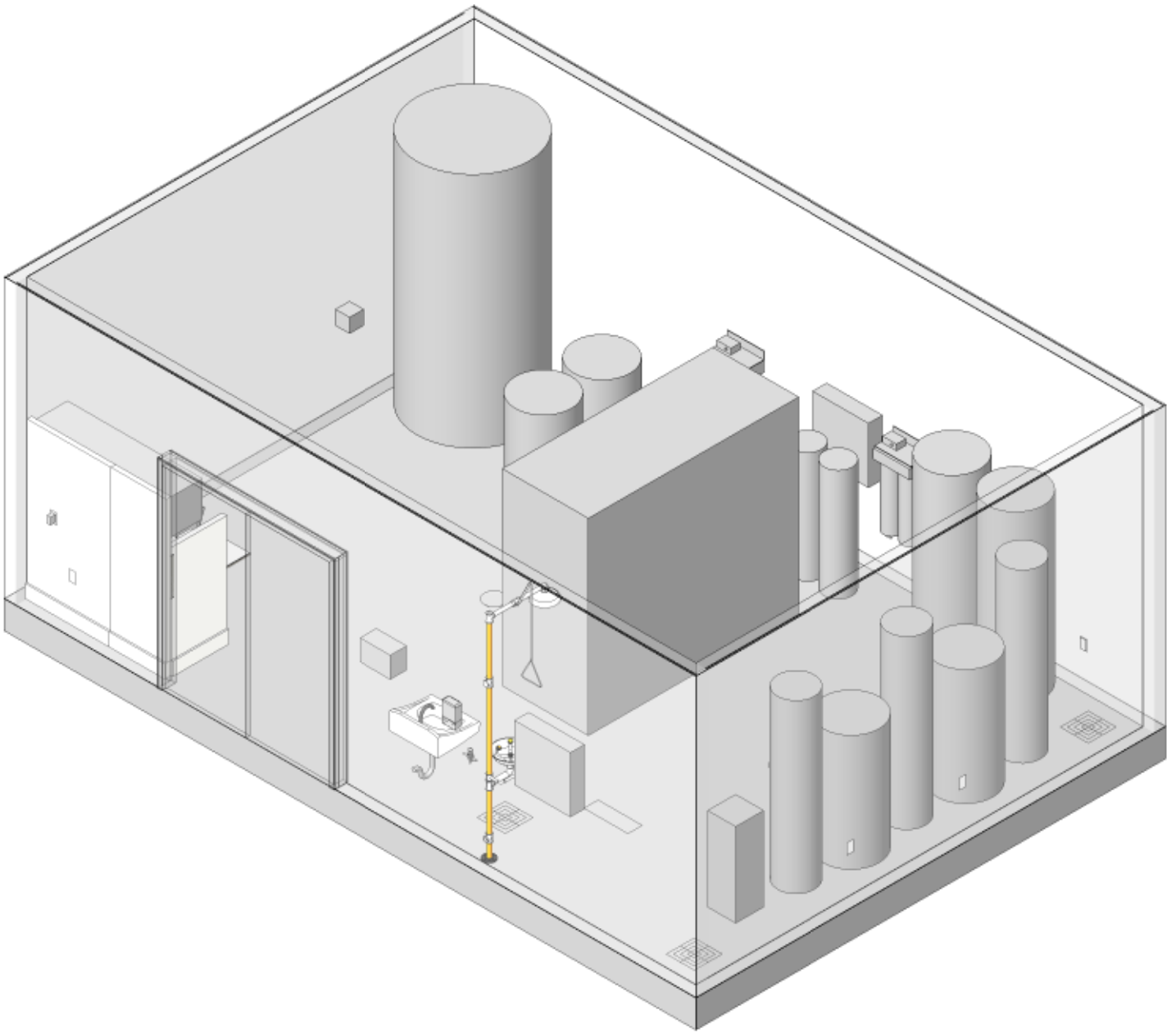

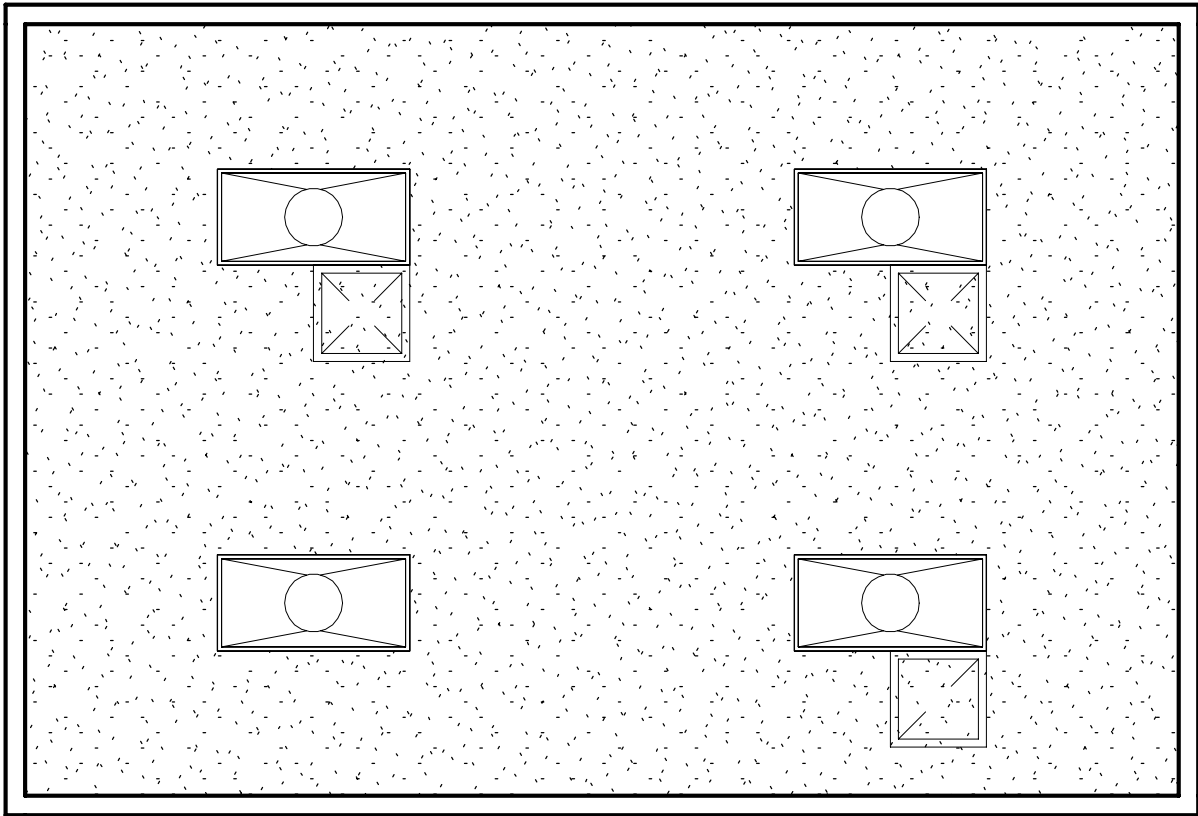

FGI GUIDELINES:

1. The room shall contain a separate treated, purified water distribution system and a drainage system independent from tap water and hand-washing system shall be provided.

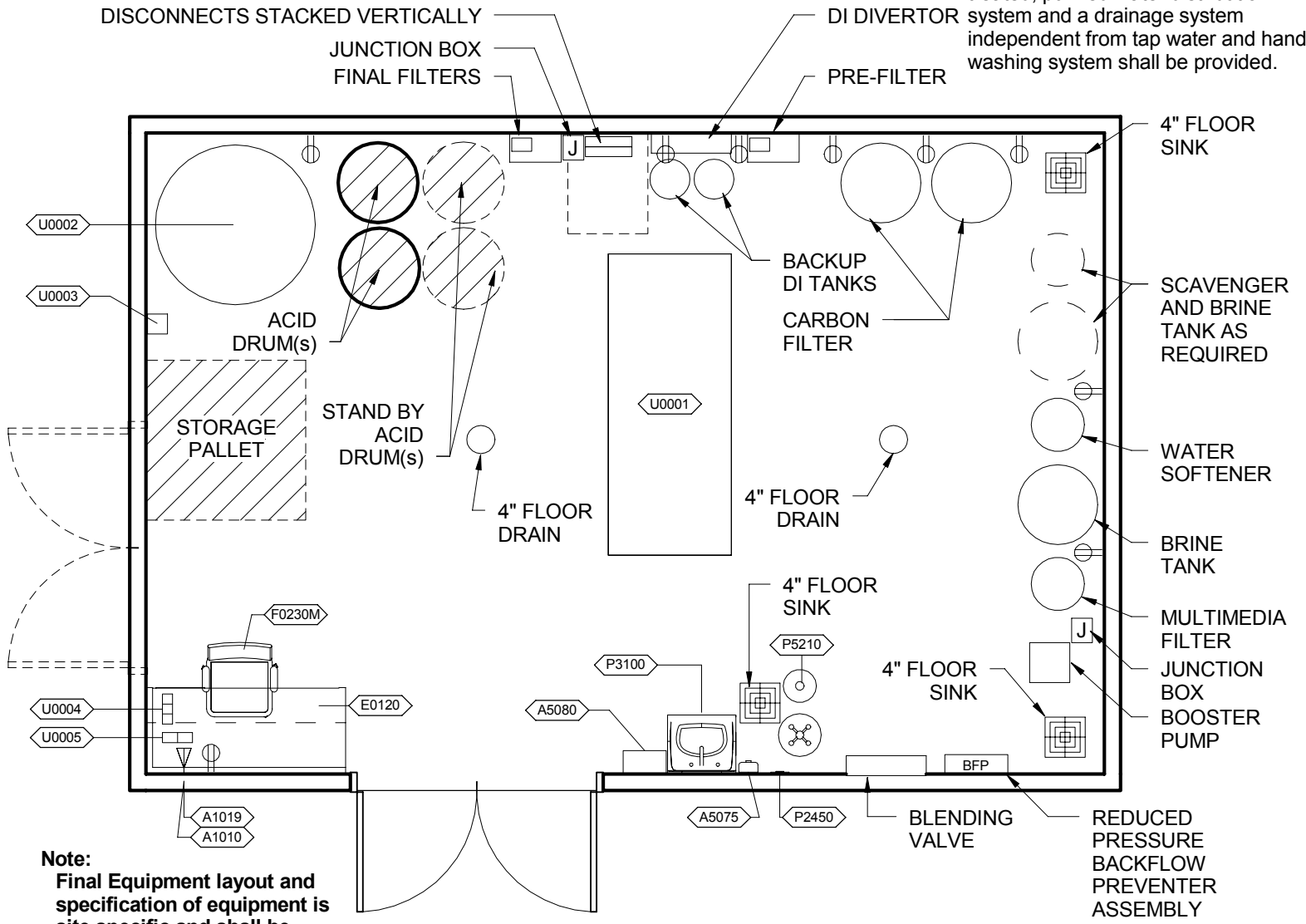

Note:
Final Equipment layout and specification of equipment is site specific and shall be provided by the A/E of record

| JSN | Nomenclature | Qty | Log Cat | Util1 | Util2 | Util3 | Util4 | Util5 | Util6 |
|--------|--|-----|---------|-------|-------|-------|-------|-------|-------|
| A1010 | Telecommunication Outlet | 1 | A | | | | | | |
| A1019 | Telephone, Wall Mounted, Multi-Line, Cordless | 1 | A | | | | | | |
| A5075 | Dispenser, Soap, Disposable | 1 | C | - | - | - | - | - | - |
| A5080 | Dispenser, Paper Towel, SS Surface Mounted | 1 | A | - | - | - | - | - | - |
| E0120 | Workstation, Straight, Free Standing, 60" W | 1 | A | - | - | - | - | - | - |
| F0230M | Chair, Drafting, Rotary | 1 | C | - | - | - | - | - | - |
| P2450 | Valve, Mixing, Thermostatic | 1 | A | A | - | - | - | - | - |
| P3100 | Lavatory, Vitreous China, Slab Type | 1 | A | D | - | - | - | - | - |
| P5210 | Shower, Safety, Freestanding, With Eye/Face Wash | 1 | C | | | | | | |
| U0001 | Direct Feed, RO Water | 1 | C | D | G | - | - | - | - |
| U0002 | Distribution System, Acid | 1 | C | - | A | - | - | - | - |
| U0003 | Pump, Drum / Barrel | 1 | - | - | A | - | - | - | - |
| U0004 | Meter, Chlorine, Battery Powered, Kit | 3 | C | - | - | - | - | - | - |
| U0005 | Meter, Water Quality, Multi Paramters, Battery Powered | 2 | C | - | - | - | - | - | - |