

Room Description: Operating Room, Labor & Delivery, C-Section (LDDR1)	NSF: 660	LDDR1	
Sheet Description: Room/Equipment Isometric	Scale:	Sheet 1	of 6

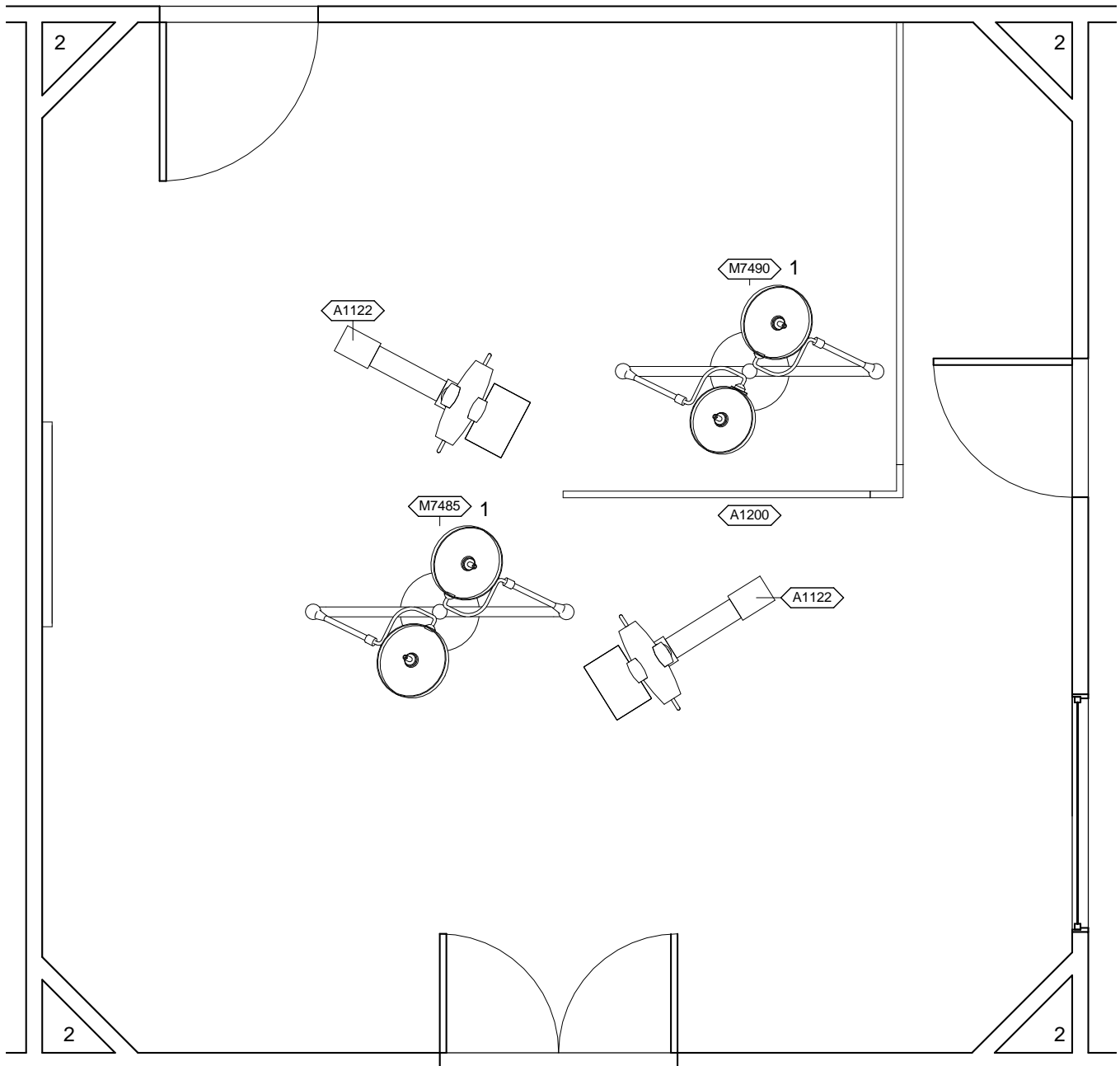

LDDR1 - CEILING MOUNTED EQUIPMENT PLAN

NOTES:

- 1. Variable intensity controller shall be integral with M7485 and M7490, Surgical Lights.
- 2. These chases are provided for the low return air. Size and shape may vary.

Room Description: Operating Room, Labor & Delivery, C-Section (LDDR1)	NSF: 660	LDDR1	
Sheet Description: Ceiling Mounted Equipment Plan	Scale: 1/4" = 1'-0"	Sheet 2	of 6

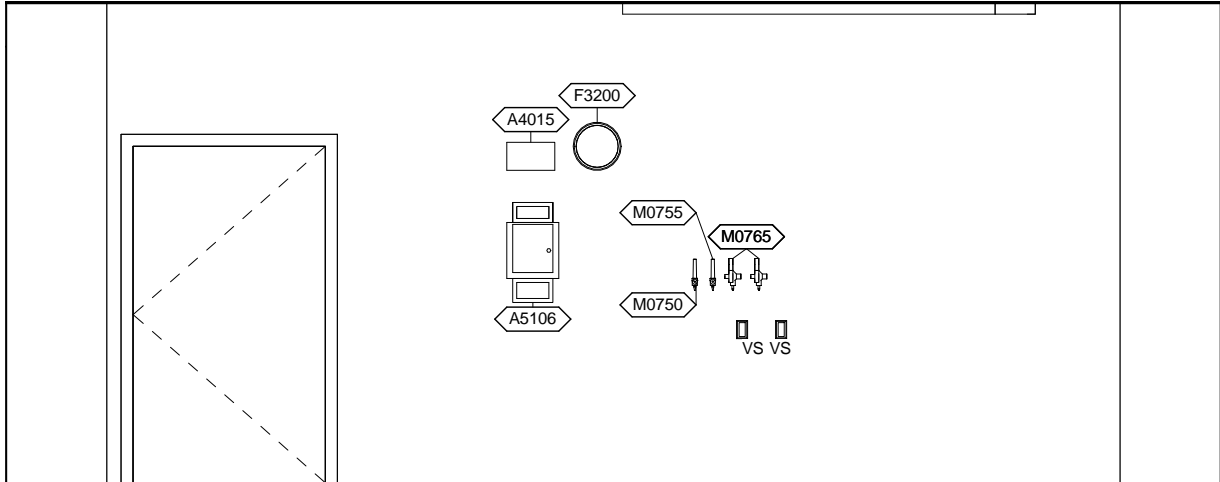

LDDR1 - NORTH ELEVATION

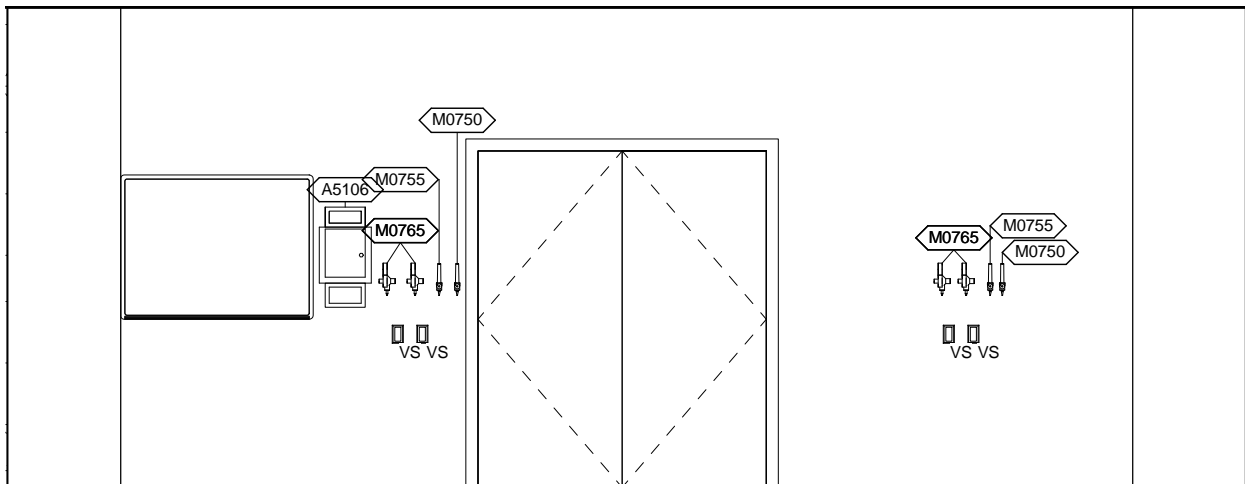

LDDR1 - SOUTH ELEVATION

Room Description: Operating Room, Labor & Delivery, C-Section (LDDR1)	NSF: 660	<h1>LDDR1</h1>	
Sheet Description: Interior Room Elevations	Scale: 1/4" = 1'-0"	Sheet <h2>4</h2>	of <h2>6</h2>

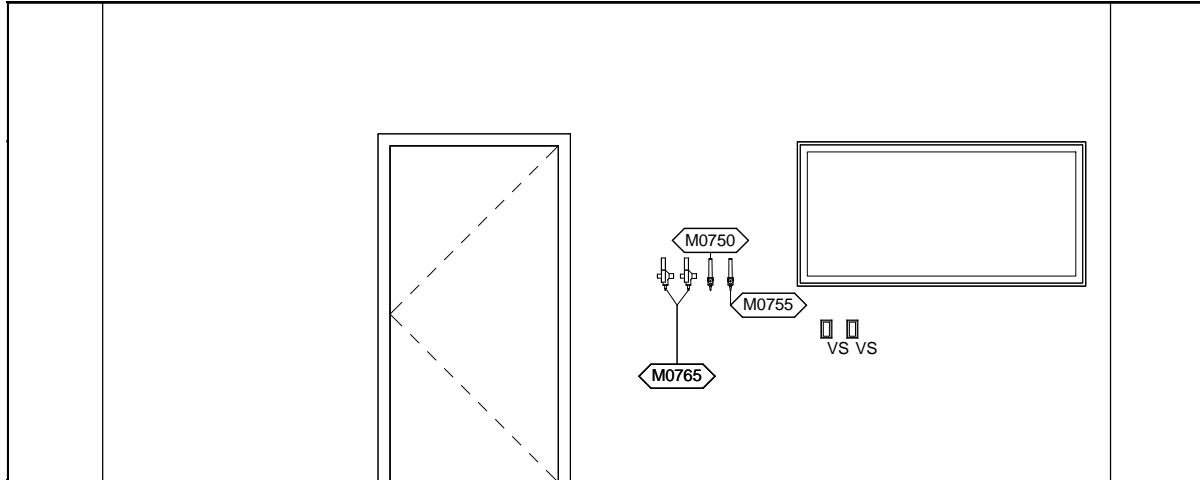

LDDR1 - EAST ELEVATION

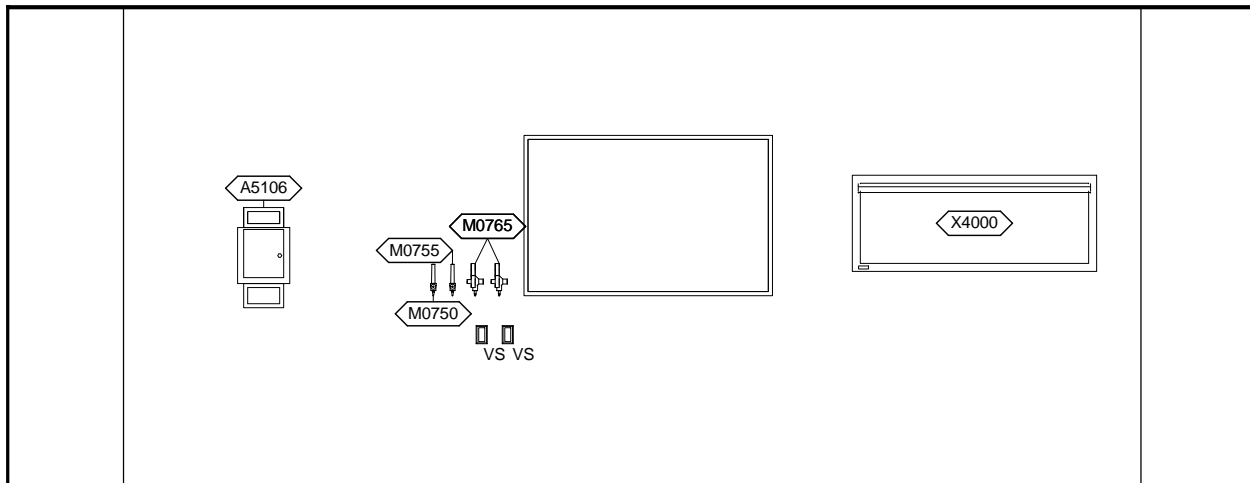

LDDR1 - WEST ELEVATION

Room Description: Operating Room, Labor & Delivery, C-Section (LDDR1)	NSF: 660	<h1>LDDR1</h1>	
Sheet Description: Interior Room Elevations	Scale: 1/4" = 1'-0"	Sheet <h2>5</h2>	of <h2>6</h2>

LDDR1 - EQUIPMENT SCHEDULE

JSN	Nomenclature	Qty	LF	Logistics				Utilities					
				AR	NA	AF	VA	1	2	3	4	5	6
A1122	Column, Equipment Arm, Ceiling Mounted, Surgery	2		A	A	A	A	-	F	G	-	-	-
A1200	Lift System, Overhead, Patient Room	1	11' - 2"	A	A	A	A	-	F	-	-	-	J
A4015	Clock, Elapsed Time, Electric	1		A	A	A	A	-	A	-	-	-	D
A5106	Waste Disposal Unit, Sharps w/Glove Dispenser	3		C	A	C	C	-	-	-	-	-	-
E0130	Workstation, Documentation, Operating, L-Shaped	1		C	C	C	C	-	-	-	-	-	-
E0703	Table, Process, Adj Height, 5 Drawer, 48"W x 24"D	1		C	C	C	C	-	-	-	-	-	-
E0954	Cart, Emergency, Mobile, 66"H x 52"W x 22"D	1		C	C	C	C	-	-	-	-	-	-
F0280	Chair, Swivel, Low Back	1		C	C	C	C	-	-	-	-	-	-
F0355	Footstool, Straight	1		C	C	C	C	-	-	-	-	-	-
F3050	Whiteboard, Dry Erase	1		A	A	A	A	-	-	-	-	-	-
F3200	Clock, Battery, 12" Diameter	1		C	C	C	C	-	-	-	-	-	-
M0630	Anesthesia Apparatus, 3 Gas	1		C	C	C	C	-	A	G	C	-	-
M0750	Flowmeter, Air, Connect w/50 PSI Supply	5		C	C	C	C	-	-	K	-	-	-
M0755	Flowmeter, Oxygen, Low Flow	5		C	C	C	C	-	-	A	-	-	-
M0765	Regulator, Vacuum	10		C	C	C	C	-	-	B	-	-	-
M0800	Center, Infant Care	1		C	C	C	C	-	A	E	-	-	-
M1801	Computer, Microprocessing, w/Flat Panel Monitor	1		C	C	C	C	-	A	-	-	-	-
M3070	Hamper, Linen, Mobile, w/Lid	1		C	C	C	C	-	-	-	-	-	-
M3072	Frame, Infectious Waste Bag w/Lid	1		C	C	C	C	-	-	-	-	-	-
M3175	Electrosurgical Unit, Dual Output	1		C	C	C	C	-	A	-	-	-	-
M4255	Stand, IV, Adjustable	3		C	C	C	C	-	-	-	-	-	-
M4266	Pump, Volumetric, Infusion, Multiple Line	3		C	C	C	C	-	A	-	-	-	-
M4815	Hypo/Hyperthermia Unit, Automatic/Manual, Mobile	1		C	C	C	C	-	A	-	-	-	-
M5030	Stool, Surgeon, Revolving	1		C	C	C	C	-	-	-	-	-	-
M7485	Light, Surg, Ceiling Mtd, Dual, Equal Dia Heads	1		A	A	A	A	-	F	-	-	-	-
M7490	Light, Surg, Ceiling Mtd, Dual, Unequal Dia Heads	1		A	A	A	A	-	F	-	-	-	-
M7655	Defibrillator/Cardioscope, 5-Lead	1		C	C	C	C	-	A	-	-	-	-
M7820	Monitor, Fetal, Bedside/Stand Alone	1		C	C	C	C	-	A	-	-	-	D
M7845	Monitor, Physiological, Bedside, 4 Channel	1		C	C	C	C	-	A	-	-	-	D
M7905	Oximeter, Pulse	1		C	C	C	C	-	A	-	-	-	-
M8800	Cart, Anesthesia	1		C	C	C	C	-	-	-	-	-	-
M8810	Stand, Mayo	3		C	C	C	C	-	-	-	-	-	-
M8825	Table, Instrument/Dressing, CRS, approx. 36x20x34	1		C	C	C	C	-	-	-	-	-	-
M8900	Carriage, Pail, CRS, Without Pail	4		C	C	C	C	-	-	-	-	-	-
M8905	Pail, Utility, CRS, Without Carriage	4		C	C	C	C	-	-	-	-	-	-
M8910	Cart, Surgical Case	1		C	C	C	C	-	-	-	-	-	-
M8940	Stool, Anesthesia, With Back	1		C	C	C	C	-	-	-	-	-	-
M8950	Warmer, Blood	1		C	C	C	C	-	B	-	-	-	-
M9095	Table, Operating, Remote Control	1		C	C	C	C	-	A	-	-	-	-
X4000	Illuminator, Film, 4 Panel, Recessed	1		A	A	A	A	-	B	-	-	-	-
X4122	Console, PACS, Remote View, 2k X 2k, 2 Monitors	1		F	F	F	F	-	A	-	-	-	-

Room Description: Operating Room, Labor & Delivery, C-Section (LDDR1)	NSF: 660	LDDR1	
Sheet Description: Equipment/Data Schedule	Scale:	Sheet 6	of 6