

| | | | |
|---|-----------------|-------------------|----------------|
| Room Description: Dental Prosthodontics Lab, Basic Service (DNPL1) | NSF: 240 | DNPL1 | |
| Sheet Description: Room/Equipment Isometric | Scale: | Sheet 1 | of 6 |

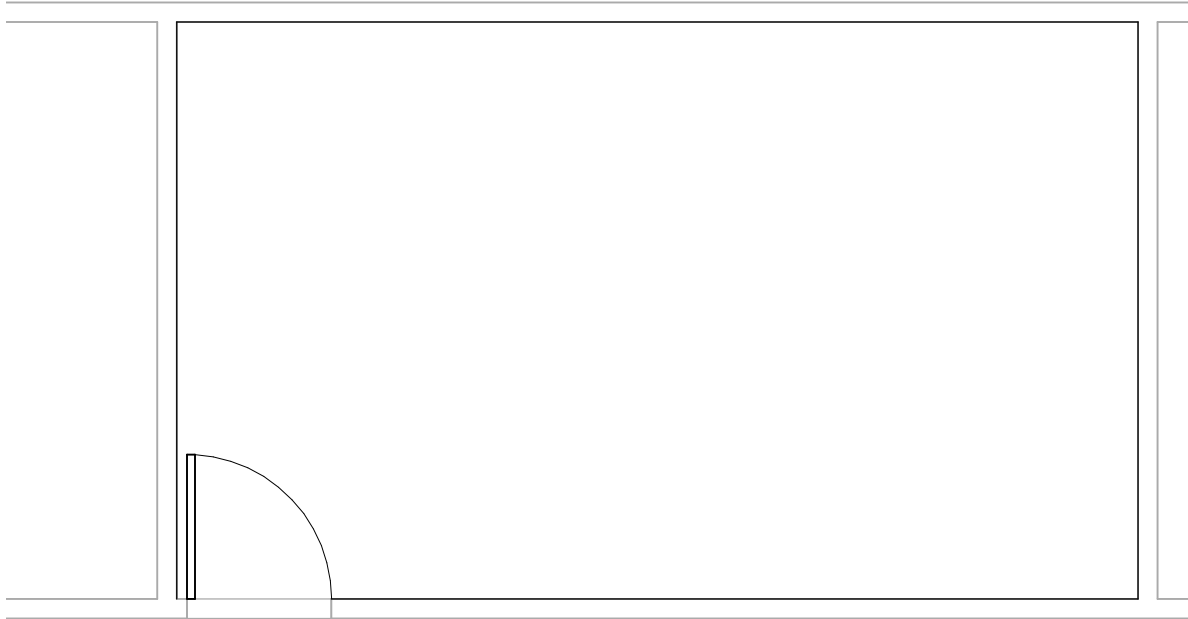

DNPL1 - CEILING MOUNTED EQUIPMENT PLAN

| | | | |
|---|----------------------------|-------------------|----------------|
| Room Description: Dental Prosthodontics Lab, Basic Service (DNPL1) | NSF: 240 | DNPL1 | |
| Sheet Description: Ceiling Mounted Equipment Plan | Scale: 1/4" = 1'-0" | Sheet 2 | of 6 |

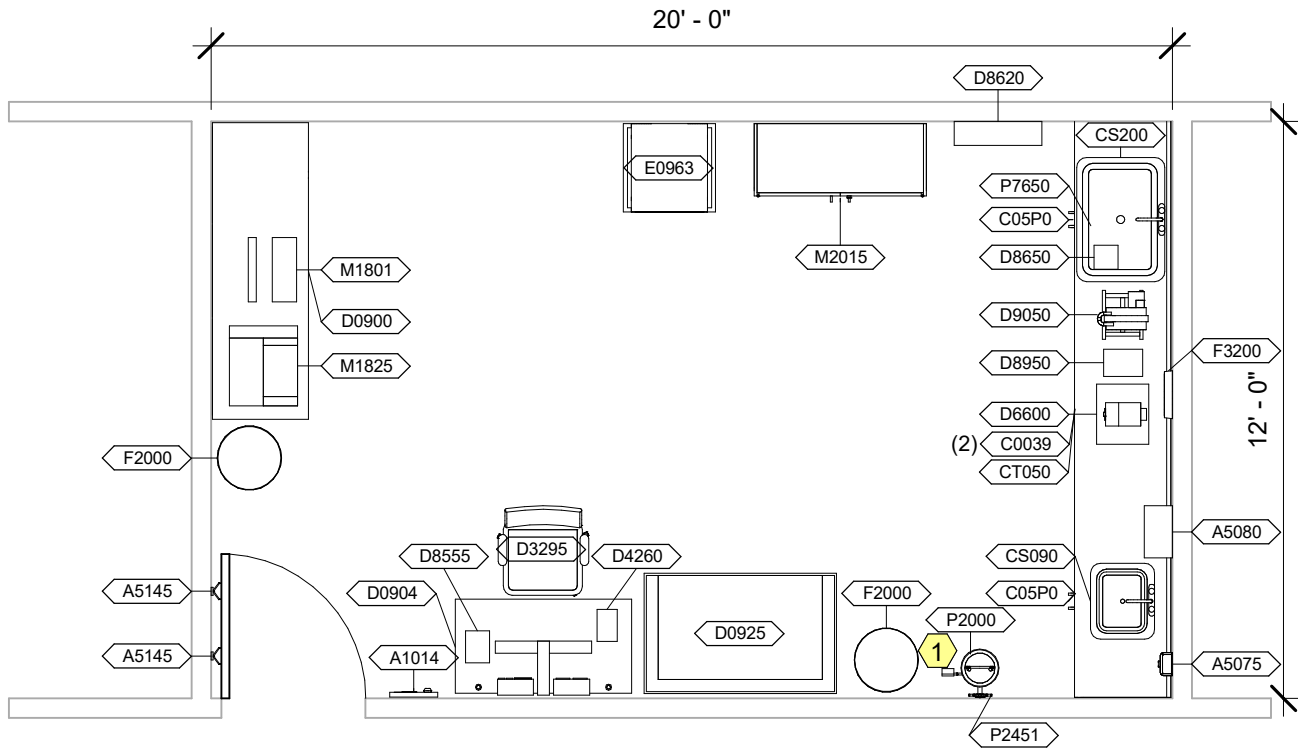

DNPL1 - NOTES

- 1 JSN P1960, Eyewash, Counter Top, may be used instead of JSN P2000, Eyewash, Wall Mounted, Hands Free.

| | | | |
|---|----------------------------|-------------------|----------------|
| Room Description: Dental Prosthodontics Lab, Basic Service (DNPL1) | NSF: 240 | DNPL1 | |
| Sheet Description: Equipment Plan | Scale: 1/4" = 1'-0" | Sheet 3 | of 6 |

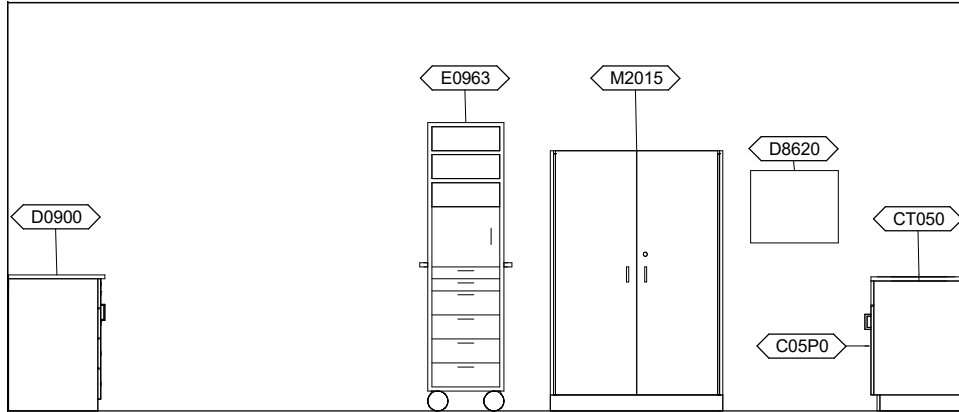

DNPL1 - NORTH ELEVATION

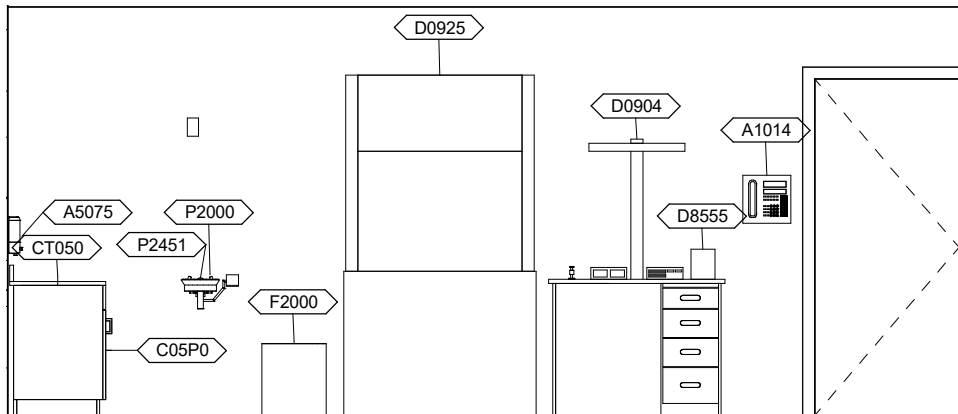

DNPL1 - SOUTH ELEVATION

| | | | |
|---|----------------------------|-------------------|----------------|
| Room Description: Dental Prosthodontics Lab, Basic Service (DNPL1) | NSF: 240 | DNPL1 | |
| Sheet Description: Interior Room Elevations | Scale: 1/4" = 1'-0" | Sheet 4 | of 6 |

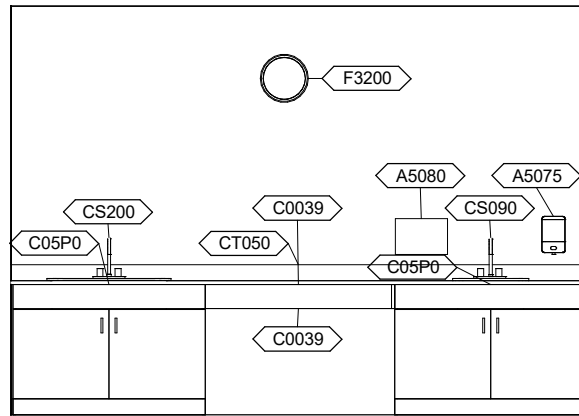

DNPL1 - EAST ELEVATION

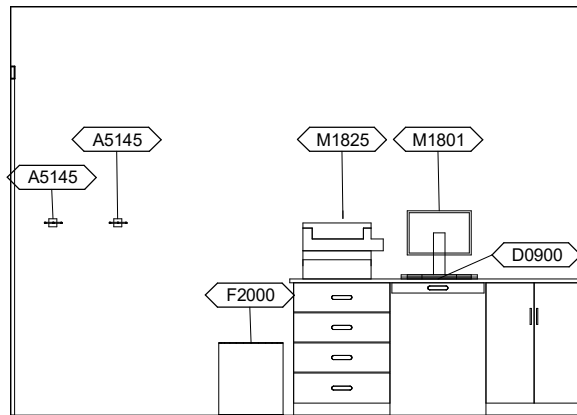

DNPL1 - WEST ELEVATION

| | | | |
|---|----------------------------|-------------------|----------------|
| Room Description: Dental Prosthodontics Lab, Basic Service (DNPL1) | NSF: 240 | DNPL1 | |
| Sheet Description: Interior Room Elevations | Scale: 1/4" = 1'-0" | Sheet 5 | of 6 |

DNPL1 - EQUIPMENT SCHEDULE

| JSN | Nomenclature | Qty | LF | Funding Category | LOGCAT |
|-------|---|-----|-----|------------------|--------|
| A1014 | Telephone, Wall Mounted, 1 Line, With Speaker 12x12 | 1 | | PP | C |
| A5075 | Dispenser, Soap, Disposable | 1 | | PP | C |
| A5080 | Dispenser, Paper Towel, SS, Surface Mounted | 1 | | RPIE | A |
| A5145 | Hook, Garment, Double, SS, Surface Mounted | 2 | | RPIE | A |
| C05P0 | Cabinet, Sink, U/C/B, 2 Door, 36x48x22 | 2 | | RPIE | A |
| C0039 | Rail, Apron, 4x48x1 | 2 | | RPIE | A |
| CS090 | Sink, SS, Single Compartment, 7.5x19x16 ID | 1 | | RPIE | A |
| CS200 | Sink, SS, Single Compartment, 12x28x16 ID | 1 | | RPIE | A |
| CT050 | Countertop, Stainless Steel | 1 | 12' | RPIE | A |
| D0900 | Workstation, Dental Lab, Receiving | 1 | | RPIE | A |
| D0904 | Workstation, Tech, Dental, Lab, Single Station | 1 | | RPIE | A |
| D0925 | Hood, Fume, Dental Acrylic, Floor Standing | 1 | | RPIE | A |
| D3295 | Chair, Rotary, Laboratory, Dental | 1 | | PP | C |
| D4260 | Handpiece, Laboratory, Dental, Electric | 1 | | PP | C |
| D6600 | Mixer / Investor, With Vacuum | 1 | | PP | C |
| D8555 | Torch, Casting/Soldering, Dental | 1 | | PP | C |
| D8620 | Bin, Plaster, 3 Compartment | 1 | | PP | C |
| D8650 | Chute, Waste, Plaster, Counter Mounted | 1 | | RPIE | A |
| D8950 | Vibrator, Dental, Heavy Duty | 1 | | PP | C |
| D9050 | Trimmer, Model, Dental, 1/4 HP | 1 | | PP | C |
| E0963 | Cart, General Storage, Mobile | 1 | | PP | C |
| F2000 | Basket, Wastepaper, Fire Resistant | 2 | | PP | C |
| F3200 | Clock, Battery, 12" Diameter | 1 | | PP | C |
| M1801 | Computer, Microprocessing, w/Flat Panel Monitor | 1 | | PP | C |
| M1825 | Printer, Computer | 1 | | PP | C |
| M2015 | Cabinet, Storage, Flammable, Freestanding | 1 | | PP | C |
| P2000 | Eyewash, Wall Mounted, Hands-Free | 1 | | RPIE | A |
| P2451 | Valve, Mixing, Thermostatic, Eyewash | 1 | | RPIE | A |
| P7650 | Trap, Plaster, Small | 1 | | RPIE | A |

| | | | |
|---|-----------------|-------------------|----------------|
| Room Description: Dental Prosthodontics Lab, Basic Service (DNPL1) | NSF: 240 | DNPL1 | |
| Sheet Description: Equipment Schedule | Scale: | Sheet 6 | of 6 |