

KEY NOTES

1. MOUNT A5145, HOOK, AT 1372 [4'-6"] AFF. PROVIDE 2-A5145'S FOR NAVY PROJECTS ONLY.  
MOUNT 1-A5145 AT 1372 [4'-6"] AFF AND 1-A5145 AT 1524 [5'-0"] AFF.
2. LENGTH OF E1500, WALL MOUNTED RAIL, TO BE DETERMINED BY MANUFACTURER/INSTALLER.
3. PROVIDE A5109, GRAB BAR, THAT COMPLIES WITH ADA.
4. COORDINATE LOCATION OF M1620, PATIENT CHART HOLDER, AND ROOM SIGNAGE.
5. COORDINATE LOCATION OF ELECTRICAL OUTLETS WITH M1802, WALL MOUNTED, FOLD DOWN COMPUTER.

EXAM, URODYNAMICS  
& TOILET/UNISEX (EXUD1/TLTU1)

UROLOGY

FLOOR/EQUIPMENT PLAN

19.45 NSM (209 NSF)

DATE: 07/12/2001

0 1000 2000



1:50 SCALE (MILLIMETERS)

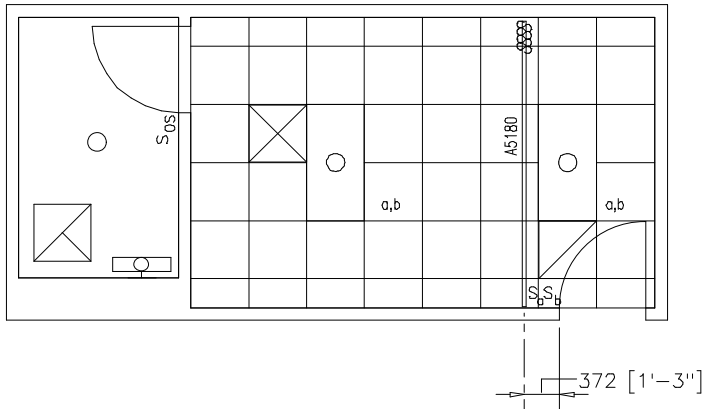

EXAM, URODYNAMICS  
& TOILET/UNISEX (EXUD1/TLTU1)

UROLOGY

CEILING PLAN

DATE: 07/12/2001

19.45 NSM (209 NSF)

0 1000 2000



1:50 SCALE (MILLIMETERS)

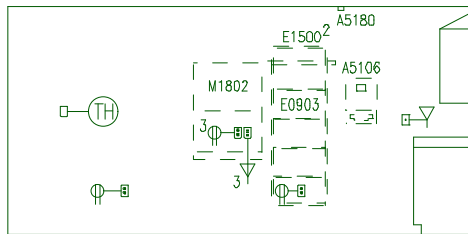
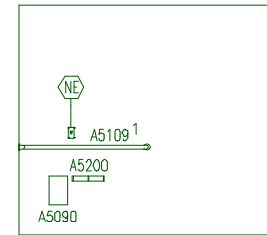
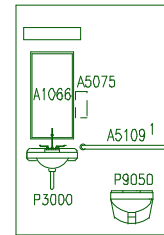
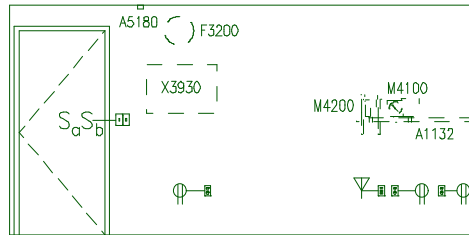
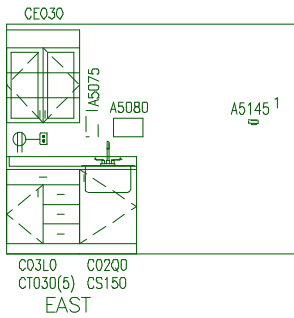

KEY NOTES

1. PROVIDE A5109, GRAB BAR, THAT COMPLIES WITH ADA.

General Notes:

1. For typical equipment mounting heights see "TYPICAL EQUIPMENT MOUNTING HEIGHTS" drawing.
2. MIL-STD-1691 data can only be accessed from the Equipment Plan.

KEY NOTES

1. MOUNT A5145, HOOK, AT 1372 [4'-6"] AFF. PROVIDE 2-A5145'S FOR NAVY PROJECTS ONLY.  
MOUNT 1-A5145 AT 1372 [4'-6"] AFF AND 1-A5145 AT 1524 [5'-0"] AFF.
2. LENGTH OF E1500, WALL MOUNTED RAIL, TO BE DETERMINED BY MANUFACTURER/INSTALLER.
3. COORDINATE LOCATION OF ELECTRICAL OUTLETS WITH M1802, WALL MOUNTED, FOLD DOWN COMPUTER.

EXAM, URODYNAMICS  
& TOILET/UNISEX (EXUD1/TLTU1)

UROLOGY

ELEVATIONS

DATE: 07/12/2001

0 1000 2000

19.45 NSM (209 NSF)

1:50 SCALE (MILLIMETERS)

Project Rooms (User Contents Only)

As of 06/09/2005

Page 1

Room Code: EXUD1 Room Qty: 1 Room Area: 160.00 Room Description: EXAM, URODYNAMICS

JSN	NOMENCLATURE	Qty	UNIT	LOG	Utl	Utl	Utl	Utl	Utl	Utl
			ISSUE	CAT	1	2	3	4	5	6
Equipment per Room:										
A1132	Rail, Accessory Mounting, Length As Required	1	LF	C	.	.	.	.	.	.
A5075	Dispenser, Soap, Disposable	1	EA	C	.	.	.	.	.	.
A5080	Dispenser, Paper Towel, SS, Surface Mounted	1	EA	A	.	.	.	.	.	.
A5106	Waste Disposal Unit, Sharps w/Glove Dispenser	1	EA	C	.	.	.	.	.	.
A5145	Hook, Garment, Double, SS, Surface Mounted	1	EA	A	.	.	.	.	.	.
A5180	Track, Cubicle, Surface Mounted, With Curtain	1	FT	A	.	.	.	.	.	.
C02Q0	Cabinet, Sink, U/C/B, 1 Door, 36x24x22	1	EA	A	.	.	.	.	.	.
C03L0	Cabinet, U/C/B, 1 DR, 3 Half DR, 1 Door, 36x30x2	1	EA	A	.	.	.	.	.	.
CE030	Cabinet, W/H, 2 SH, 2 GDO, Sloping Top, 38x30x13	1	EA	A	.	.	.	.	.	.
CS150	Sink, SS, Single Compartment, 10x19x16 ID	1	EA	A	D	.	.	.	.	.
CT030	Countertop, High Pressure Laminate	5	LF	A	.	.	.	.	.	.
E0903	Locker, Supply, w/Shelves, Wall Mtd, 23"W x 20"D	1	EA	C	.	.	.	.	.	.
E1500	Rail, MOD, W/MNTD, HX144XD	1	EA	C	.	.	.	.	.	.
F0205	Chair, Side With Arms	1	EA	C	.	.	.	.	.	.
F0340	Stool, Self Adjusting	1	EA	C	.	.	.	.	.	.
F0355	Footstool, Straight	1	EA	C	.	.	.	.	.	.
F2000	Basket, Wastepaper, Round, Metal, 18 H x 16 Dia.	1	EA	C	.	.	.	.	.	.
F3200	Clock, Battery, 12" Diameter	1	EA	C	.	.	.	.	.	.
M1620	Holder, Chart, Patient, Wall or Door Mounted	1	EA	A	.	.	.	.	.	.
M1802	Work Station, Computer, Retractable, Wall Mount	1	EA	C	.	G	.	.	.	D
M3072	Frame, Infectious Waste Bag w/Lid	1	EA	C	.	.	.	.	.	.
M4100	Sphygmomanometer, Aneroid, Wall Mounted	1	EA	C	.	.	.	.	.	.
M4200	Otoscope/Ophthalmoscope, Wall Mounted	1	EA	C	.	A	.	.	.	.
M4255	Stand, IV, Adjustable	1	EA	C	.	.	.	.	.	.
M4800	Urodynamic Measurement System w/Video	1	EA	C	.	A	.	.	.	.
M4801	Commode Chair	1	ea	C	.	.	.	.	.	.
M7401	Light, Exam, Mobile, Spotlight, Mobile Stand	1	EA	.	.	A	.	.	.	.
M8810	Stand, Mayo	1	EA	C	.	.	.	.	.	.
M9100	Table, Procedure, Urological	1	EA	C	.	A	.	.	.	.
X3930	Illuminator, Film, Double, Wall Mounted, 20x29x6	1	EA	C	.	A	.	.	.	.
A1066	Mirror, Float Glass, With SS Frame, 36X18	1	EA	A	.	.	.	.	.	.
A5075	Dispenser, Soap, Disposable	1	EA	C	.	.	.	.	.	.
A5080	Dispenser, Paper Towel, SS, Surface Mounted	1	EA	A	.	.	.	.	.	.
A5090	Disposal, Sanitary Napkin, SS, Surface Mounted	1	EA	A	.	.	.	.	.	.
A5109	Grab Bar, 1-1/4" Dia., SS, 2 Wall, W/C Accessibl	1	EA	A	.	.	.	.	.	.

A5145	Hook, Garment, Double, SS, Surface Mounted	1	EA	A	.	.	.	.	.	.
A5200	Dispenser, Toilet Tissue, SS, 2-Roll, Surface Mn	1	EA	A	.	.	.	.	.	.
F2000	Basket, Wastepaper, Round, Metal, 18 H x 16 Dia.	1	EA	C	.	.	.	.	.	.
P3000	Lavatory, Vitreous China, Straight Back	1	EA	A	D	.	.	.	.	.
P9050	Toilet, Wall Hung, Siphon Jet	1	EA	A	B	.	.	.	.	.

=====

\*\*\*GRAND TOTAL\*\*\* 44