



DNPL2 - INTERIOR DESIGN

Floor Finish		Wall Finish		Ceiling Finish		Room Height	Room Noise		
Preferred	Alternate	Preferred	Alternate	Preferred	Alternate	ft - in	Min NC	Max NC	SC
SV	VT	GLG	GPT	AT1	-	8' - 6"	35	40	40

DNPL2 - DOOR SCHEDULE

Mark	Type	Count	Height	Width	Notes
			ft - in	ft - in	
A	Single-Flush	2	7' - 0"	3' - 0"	

Room Description: Dental Prosthetics Lab, Medium

NSF: 480

DNPL2

Plate Description: Room/Equipment Isometric

Scale:

Sheet

1

of

8

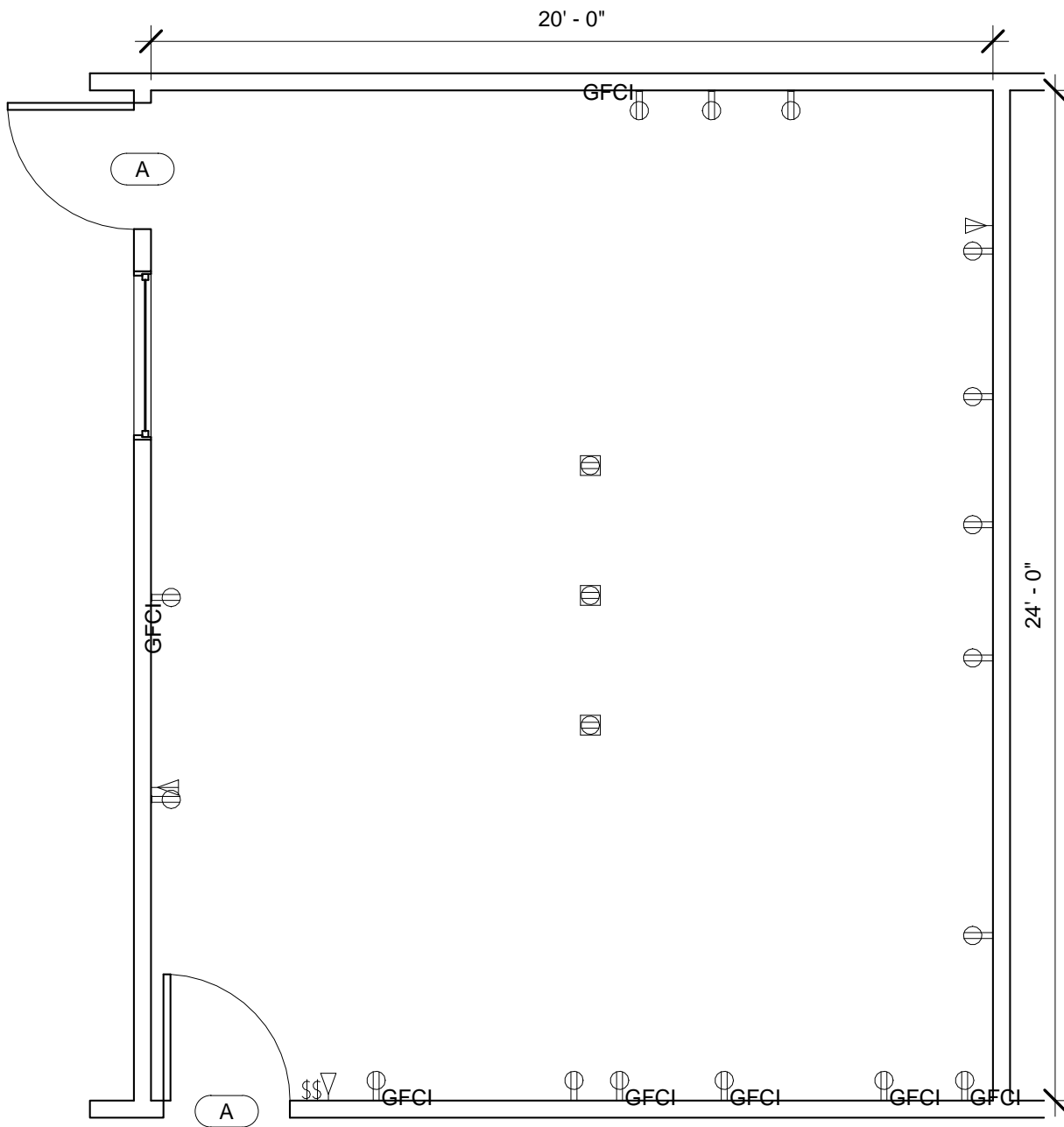

DNPL2 - FLOOR PLAN

Room Description: Dental Prosthodontics Lab, Medium	NSF: 480	DNPL2	
Plate Description: Floor Plan	Scale: 1/4" = 1'-0"	Sheet 2	of 8

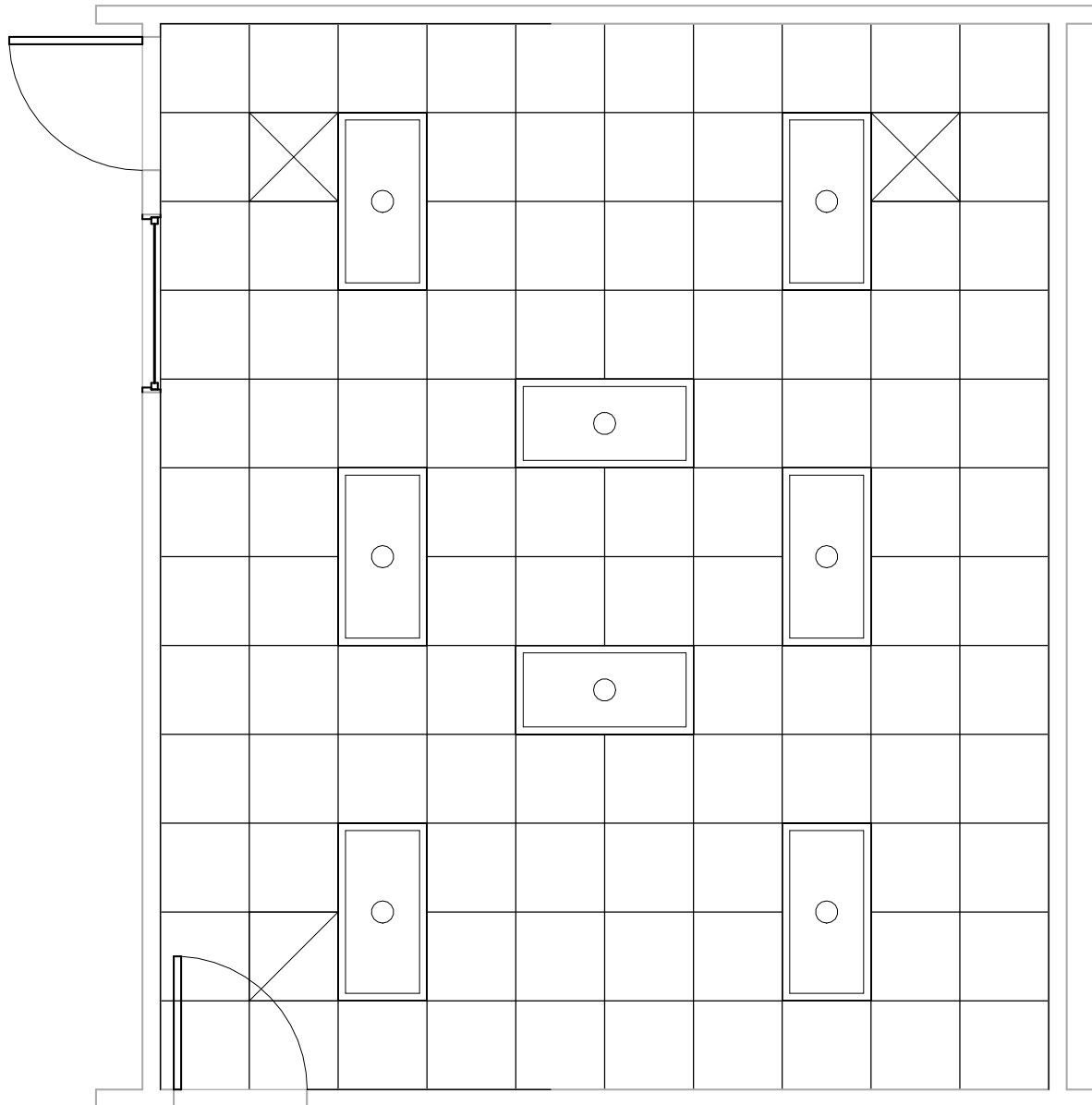

DNPL2 - CEILING PLAN

Room Description: Dental Prosthodontics Lab, Medium	NSF: 480	DNPL2	
Plate Description: Reflected Ceiling Plan	Scale: 1/4" = 1'-0"	Sheet 3	of 8

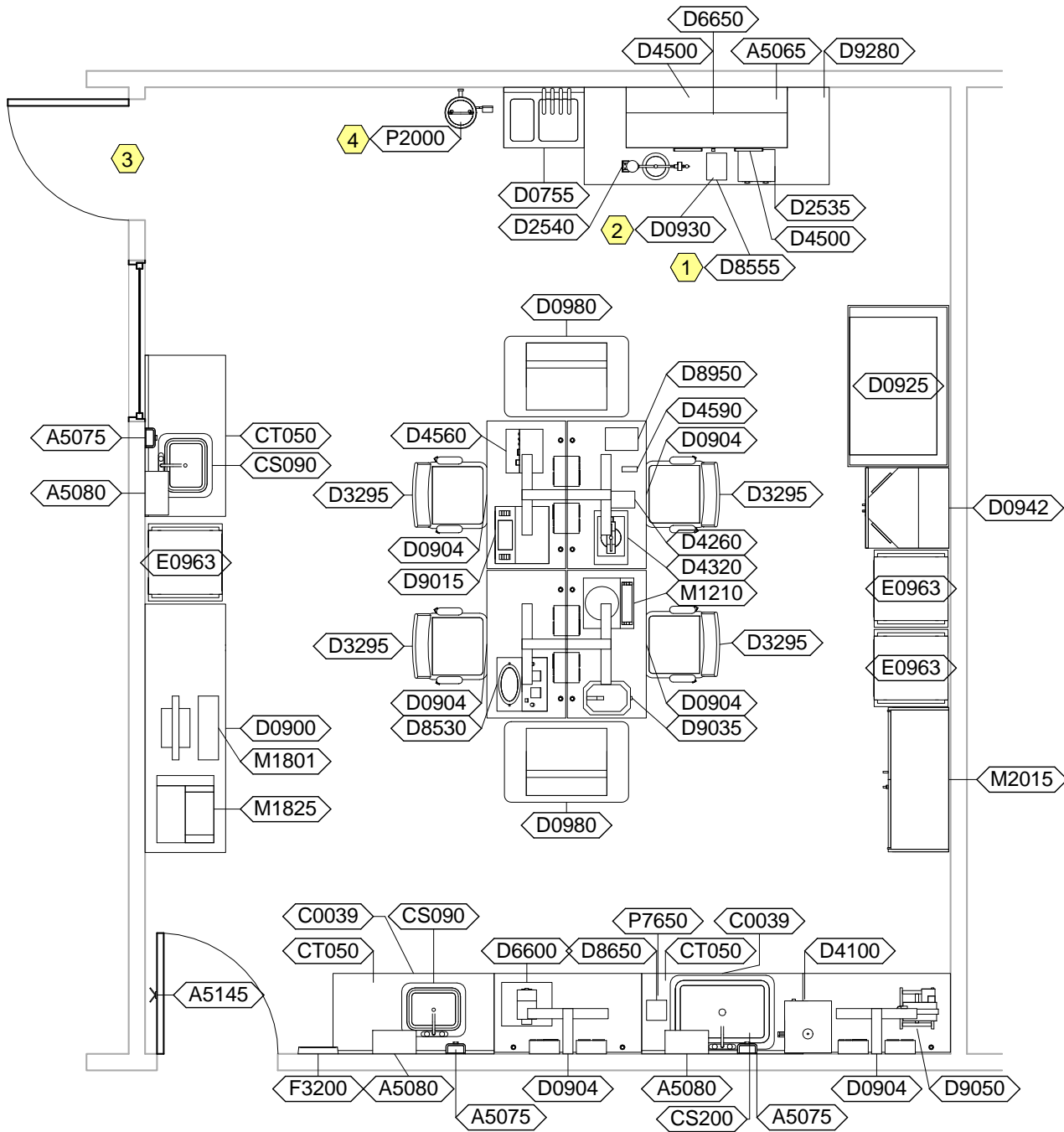

DNPL2 - NOTES

- 1 Provide oxygen tanks for JSN D8555, Torch.
- 2 Provide casting ring cool-down with steel grid for JSN D0930, Workstation.
- 3 If DNPL2, Dental Prostodontics Lab, Medium, is located adjacent to DNPC2, Dental, Porcelain/Ceramic Room, Medium, then coordinate the door and window locations.
- 4 JSN P1960, Eyewash, Counter Top, may be used instead of JSN P2000, Eyewash, Wall Mounted, Hands Free.

Room Description: Dental Prostodontics Lab, Medium	NSF: 480	DNPL2	
Plate Description: Equipment Plan	Scale: 1/4" = 1'-0"	Sheet 4	of 8

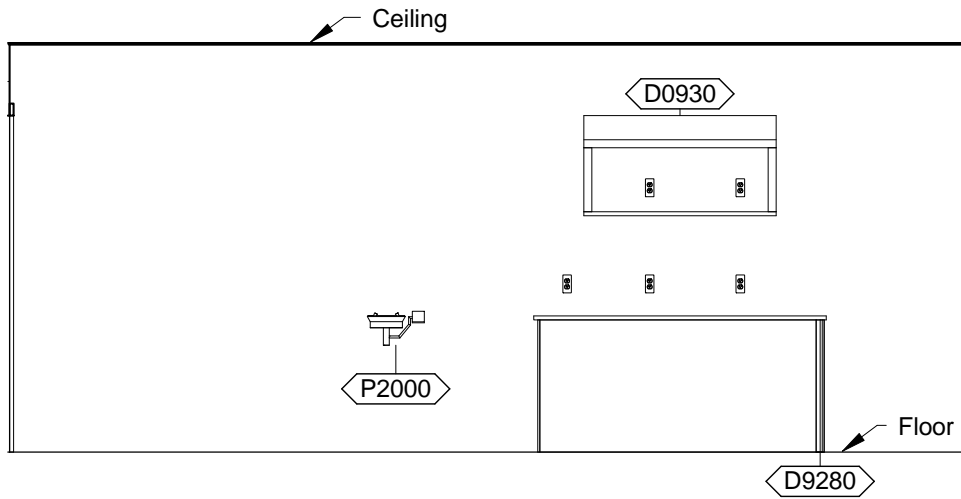

DNPL2 - PLAN NORTH

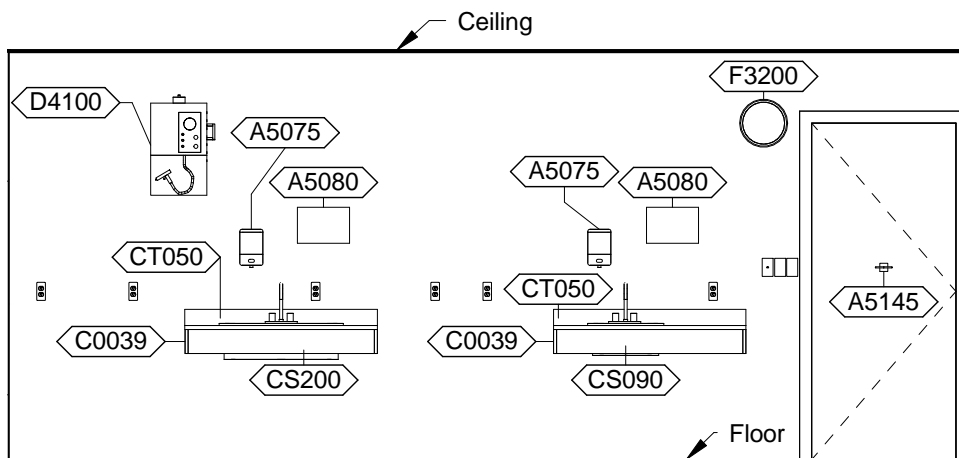

DNPL2 - PLAN SOUTH

Room Description: Dental Prosthodontics Lab, Medium	NSF: 480	DNPL2	
Plate Description: Interior Room Elevations	Scale: 1/4" = 1'-0"	Sheet 5	of 8

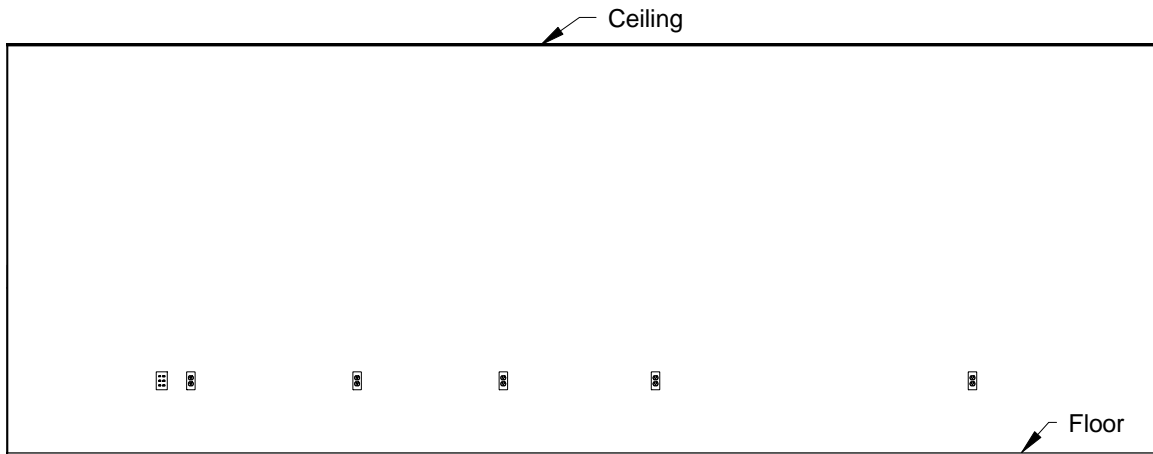

DNPL2 - PLAN EAST

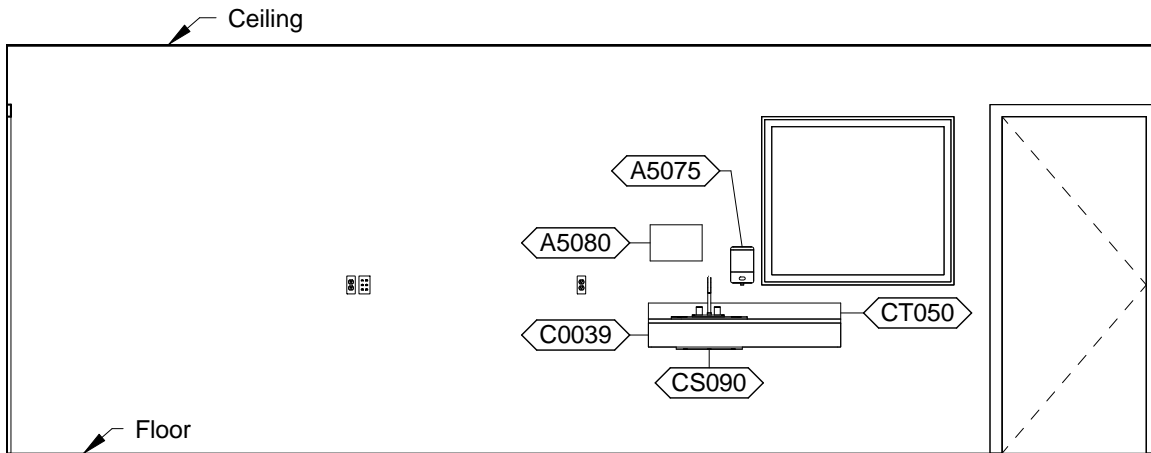

DNPL2 - PLAN WEST

Room Description: Dental Prosthetics Lab, Medium	NSF: 480	DNPL2	
Plate Description: Interior Room Elevations	Scale: 1/4" = 1'-0"	Sheet 6	of 8

DNPL2 - EQUIPMENT SCHEDULE

JSN	Nomenclature	Qty	AR	Logistics				Utilities					
				NA	AF	VA	1	2	3	4	5	6	
A5065	Cabinet, Narcotic, U/C or Ctr, With Safe	1	C	C	C	C	-	-	-	-	-	-	
A5075	Dispenser, Soap, Disposable	3	C	C	C	C	-	-	-	-	-	-	
A5080	Dispenser, Paper Towel, SS, Surface Mounted	3	A	A	A	A	-	-	-	-	-	-	
A5145	Hook, Garment, Double, SS, Surface Mounted	1	A	A	A	A	-	-	-	-	-	-	
C0039	Rail, Apron, 4x48x1	3	A	A	A	A	-	-	-	-	-	-	
CS090	Sink, SS, Single Compartment, 7.5x19x16 ID	2	A	A	A	A	D	-	-	-	-	-	
CS200	Sink, SS, Single Compartment, 12x28x16 ID	1	A	A	A	A	D	-	-	-	-	-	
CT050	Countertop, Stainless Steel	3	A	A	A	A	-	-	-	-	-	-	
D0755	Tank Assembly, Boilout/Curing, Double	1	A	A	A	A	D	A	-	-	A	E	
D0900	Workstation, Dental Lab, Receiving	1	A	A	A	A	-	-	-	-	-	-	
D0904	Workstation, Tech, Dental, Lab, Single Station	6	A	A	A	A	-	A	D	-	A	-	
D0925	Hood, Fume, Dental Acrylic, Floor Standing	1	A	A	A	A	D	A	-	-	-	E	
D0930	Workstation, Dental Lab, Casting	1	A	A	A	A	-	A	-	-	-	E	
D0942	Workstation, Dental Lab, Microblasting	1	A	F	F	F	-	A	D	-	-	-	
D0980	Workstation, Dental Lab, Polishing, Single	2	A	A	A	A	-	A	-	-	-	-	
D2535	Welder, Tack, Orthodontic	1	C	C	C	C	-	A	-	-	-	-	
D2540	Casting Machine, Manual, Broken Arm	1	-	-	-	-	-	-	-	-	-	-	
D3295	Chair, Rotary, Laboratory, Dental	4	C	C	C	C	-	-	-	-	-	-	
D4100	Cleaner, Steam, Dental	1	-	-	-	-	D	D	-	-	-	-	
D4260	Handpiece, Laboratory, Dental, Electric	1	C	C	C	C	-	A	-	-	-	-	
D4320	Press, Flask, Hydraulic, Single Flask	1	C	C	C	C	-	-	-	-	-	-	
D4500	Furnace, Laboratory, Dental, Burnout	2	C	C	C	C	-	A	-	-	-	-	
D4560	Engine, Dental, Bench, Electric	1	C	C	C	C	-	A	-	-	-	-	
D4590	Chisel, Dental, Pneumatic	1	C	C	C	C	-	-	D	-	-	-	
D6600	Mixer / Investor, With Vacuum	1	-	-	-	-	-	A	-	-	-	-	
D6650	Former, Vacuum, With Motor, Vacuum Pump, Heater	1	C	C	C	C	-	A	-	-	-	-	
D8530	Polisher, Electrochemical	1	C	C	C	C	-	A	-	-	-	-	
D8555	Torch, Casting/Soldering, Dental	1	C	C	C	C	-	-	C	-	A	E	
D8650	Chute, Waste, Plaster, Counter Mounted	1	A	A	A	A	-	-	-	-	-	-	
D8950	Vibrator, Dental, Heavy Duty	1	C	C	C	C	-	A	-	-	-	-	
D9015	Microfinisher, Dental, Counter Mounted	1	A	A	A	A	-	A	D	-	-	-	
D9035	Driver, Model Indexing Pins	1	C	C	C	C	-	A	-	-	-	-	
D9050	Trimmer, Model, Dental, 1/4 HP	1	-	-	-	-	B	A	-	-	-	-	
D9280	Legs, Rail, Apron	1	A	A	A	A	-	-	-	-	-	-	
E0963	Cart, General Storage, Mobile	3	C	C	C	C	-	-	-	-	-	-	
F3200	Clock, Battery, 12" Diameter	1	C	C	C	C	-	-	-	-	-	-	
M1210	Balance, Electronic, Laboratory/Pharmacy	1	C	C	C	C	-	A	-	-	-	-	
M1801	Computer, Microprocessing, w/Flat Panel Monitor	1	C	C	C	C	-	A	-	-	-	-	
M1825	Printer, Computer	1	C	C	C	C	-	A	-	-	-	-	
M2015	Cabinet, Storage, Flammable, Freestanding	1	C	C	C	C	-	-	-	-	-	-	
P2000	Eyewash, Wall Mounted, Hands-Free	1	A	A	A	A	B	-	-	-	-	-	
P7650	Trap, Plaster, Small	1	A	A	A	A	I	-	-	-	-	-	

Room Description: Dental Prosthodontics Lab, Medium	NSF: 480	DNPL2	
Plate Description: Equipment Schedule	Scale:	Sheet 7	of 8

DNPL2 - DATA/ELECTRICAL EQUIPMENT

JSN	Nomenclature	Qty	Logistics			
			AR	NA	AF	VA
A1010	Telecommunication Outlet	2	A	A	A	A
A1014	Telephone, Wall Mounted, 1 Line, with Speaker	1	A	A	A	A

Room Description: Dental Prosthodontics Lab, Medium	NSF: 480	DNPL2	
Plate Description: Equipment Schedule	Scale:	Sheet 8	of 8