

Room Description: Dental, Porcelain/Ceramic Room, Medium (DNPC2)	NSF: 180	DNPC2	
Sheet Description: Room/Equipment Isometric	Scale:	Sheet 1	of 5

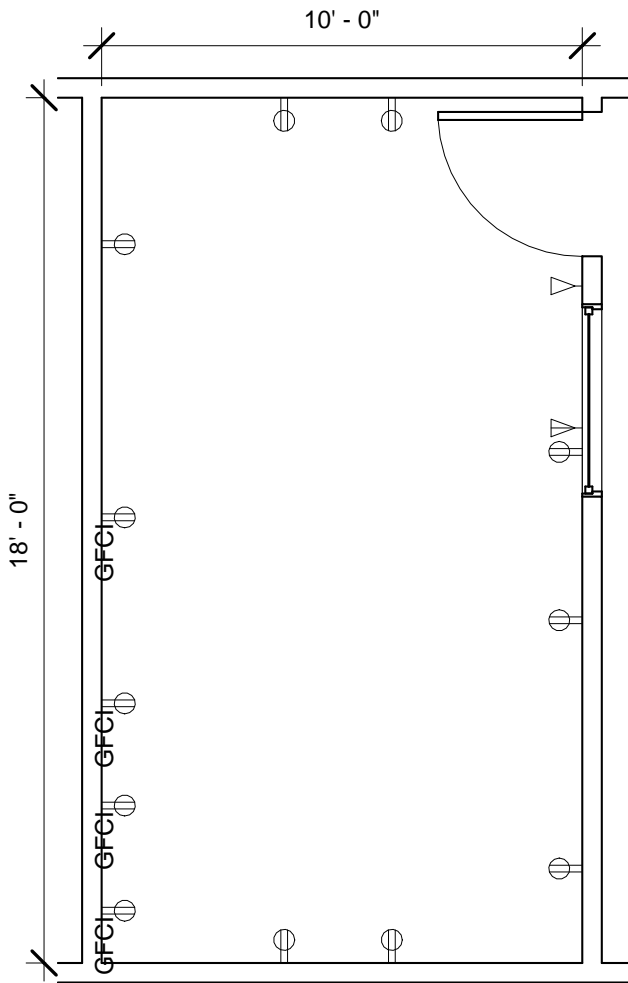

DNPC2 - FLOOR PLAN

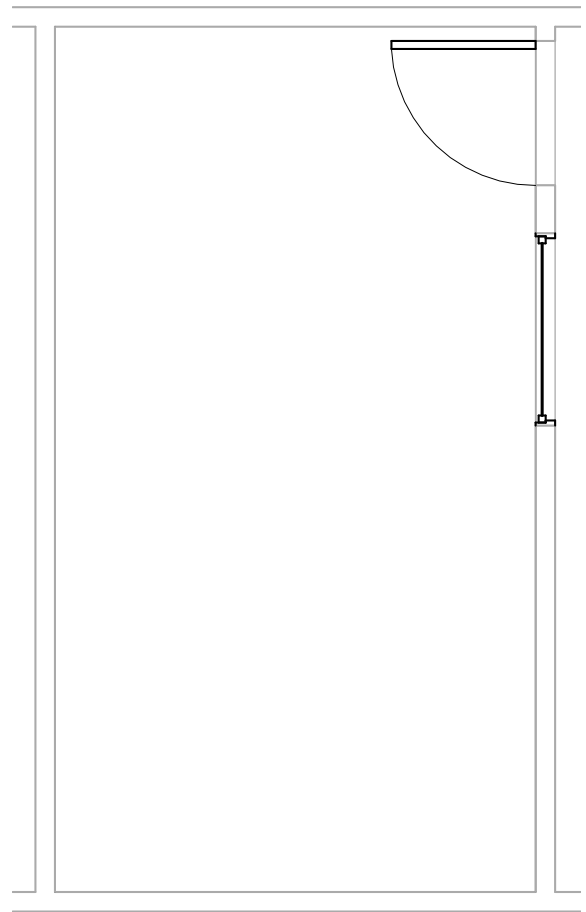

DNPC2 - CEILING MOUNTED EQUIPMENT PLAN

Room Description: Dental, Porcelain/Ceramic Room, Medium (DNPC2)	NSF: 180	DNPC2	
Sheet Description: Floor & Ceiling Mounted Equipment Plans	Scale: 1/4" = 1'-0"	Sheet 2	of 5

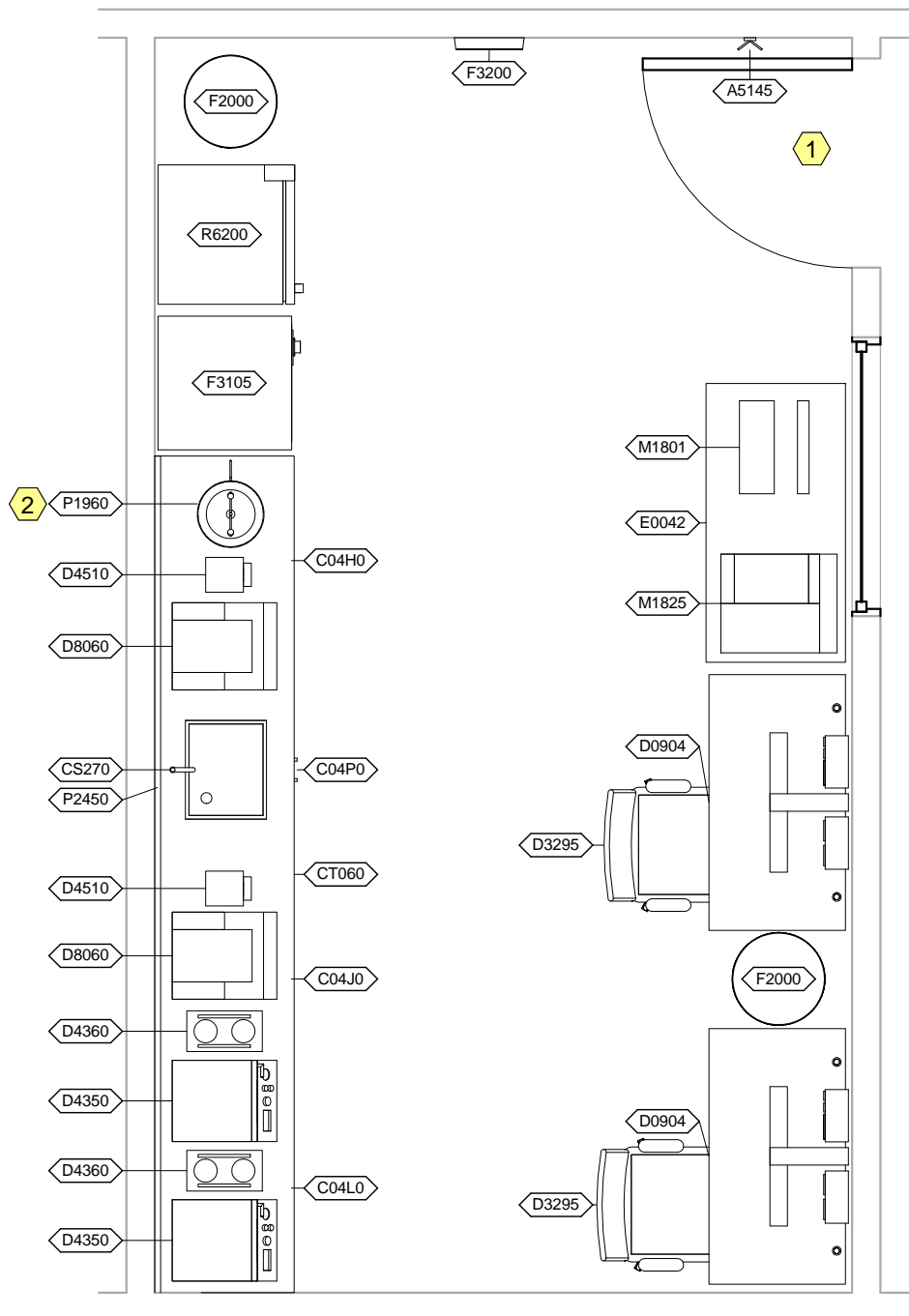

DNPC2 - NOTES

- 1 If DNPC2, Dental, Porcelain/Ceramic Room, Medium, is located adjacent to DNPL2, Dental Prosthodontics Lab, Medium, then coordinate the door and window locations.
- 2 JSN P2000, Eyewash, Wall Mounted, Hands Free, may be used instead of JSN P1960, Eyewash, Counter Top.

Room Description: Dental, Porcelain/Ceramic Room, Medium (DNPC2)	NSF: 180	<h1>DNPC2</h1>	
Sheet Description: Equipment Plan	Scale: 3/8" = 1'-0"	Sheet <h2>3</h2>	of <h2>5</h2>

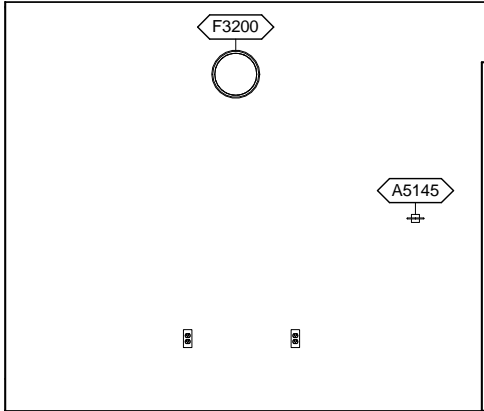

DNPC2 - NORTH ELEVATION

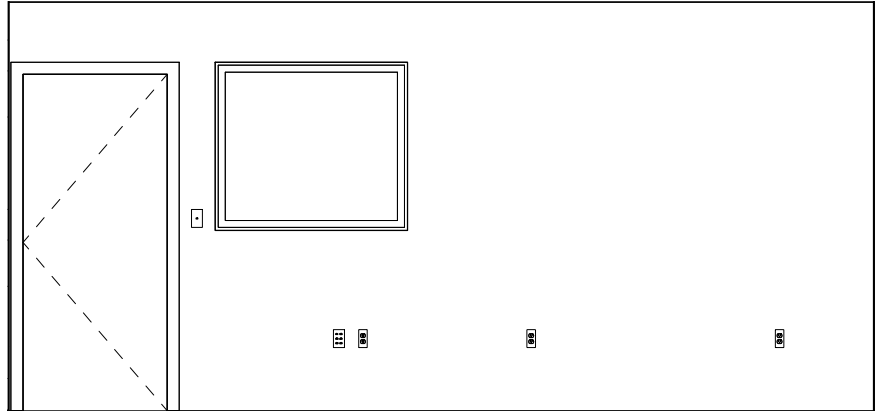

DNPC2 - EAST ELEVATION

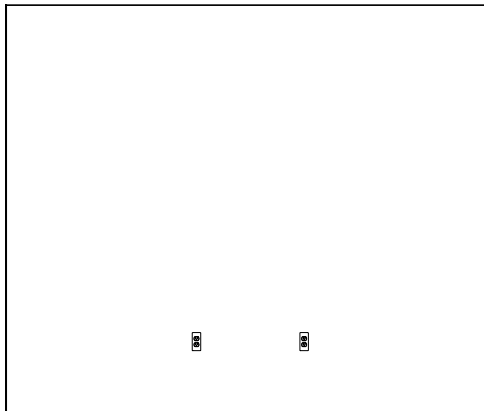

DNPC2 - SOUTH ELEVATION

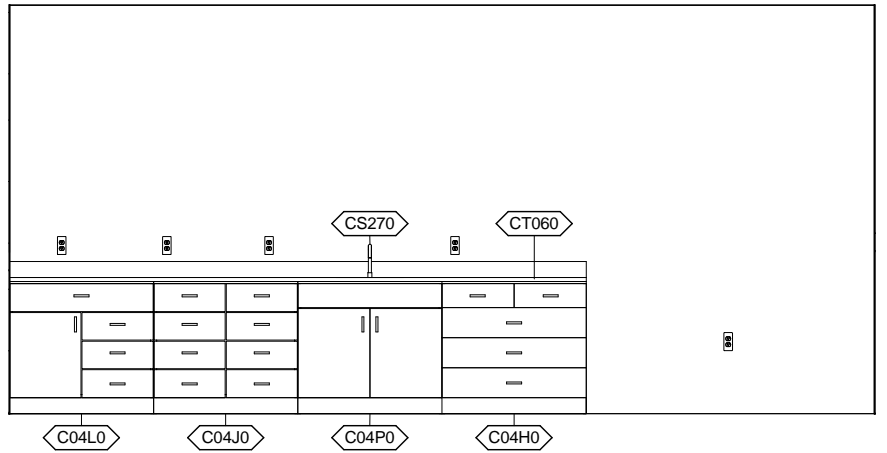

DNPC2 - WEST ELEVATION

Room Description: Dental, Porcelain/Ceramic Room, Medium (DNPC2)	NSF: 180	<h1>DNPC2</h1>	
Sheet Description: Interior Room Elevations	Scale: 1/4" = 1'-0"	Sheet <h2>4</h2>	of <h2>5</h2>

DNPC2 - EQUIPMENT SCHEDULE

JSN	Nomenclature	Qty	LF	Logistics				Utilities					
				AR	NA	AF	VA	1	2	3	4	5	6
A5145	Hook, Garment, Double, SS, Surface Mounted	1		A	A	A	A	-	-	-	-	-	-
C04H0	Cabinet, U/C/B, 2 Half Drawer, 3 Drawer, 36x36x22	1		A	A	A	A	-	-	-	-	-	-
C04J0	Cabinet, U/C/B, 8 Half Drawer, 36x36x22	1		A	A	A	A	-	-	-	-	-	-
C04L0	Cabinet, U/C/B, 1 DR, 3 Half DR, 1 Door, 36" W	1		A	A	A	A	-	-	-	-	-	-
C04P0	Cabinet, Sink, U/C/B, 2 Door, 36x36x22	1		A	A	A	A	-	-	-	-	-	-
CS270	Sink, Epoxy Resin, 11x18x15 ID	1		A	A	A	A	D	-	-	-	-	-
CT060	Countertop, Modified Epoxy Resin	1	12'-0"	A	A	A	A	-	-	-	-	-	-
D0904	Workstation, Tech, Dental, Lab, Single Station	2		A	A	A	A	-	A	D	-	A	-
D3295	Chair, Rotary, Laboratory, Dental	2		C	C	C	C	-	-	-	-	-	-
D4350	Oven, Curing, Dental	2		C	C	C	C	-	A	-	-	-	-
D4360	Pump, Vacuum, Dental Oven	2		C	C	C	C	-	A	-	-	-	-
D4510	Furnace, Laboratory, Porcelain Glazing	2		C	C	C	C	-	A	-	-	-	-
D8060	Furnace, Porcelain, Vacuum	2		C	C	C	C	-	B	-	-	-	-
E0042	Workcenter, Computer, Free Standing, 48" W	1		C	C	C	C	-	-	-	-	-	-
F2000	Basket, Wastepaper, Round, Metal	2		C	C	C	C	-	-	-	-	-	-
F3105	Safe, F/S , Class 5	1		C	C	C	C	-	-	-	-	-	-
F3200	Clock, Battery, 12" Diameter	1		C	C	C	C	-	-	-	-	-	-
M1801	Computer, Microprocessing, w/Flat Panel Monitor	1		C	C	C	C	-	A	-	-	-	-
M1825	Printer, Computer	1		C	C	C	C	-	A	-	-	-	-
P1960	Eyewash, Counter Top	1		A	A	A	A	B	-	-	-	-	-
P2450	Valve, Mixing, Thermostatic	1		A	A	A	A	A	-	-	-	-	-
R6200	Refrigerator, U/C or F/S, 5 Cu Ft	1		C	C	C	C	-	A	-	-	-	-

DNPC2 - DATA/TELEPHONE EQUIPMENT

JSN	Nomenclature	Qty	Logistics			
			AR	NA	AF	VA
A1010	Telecommunication Outlet	1	A	A	A	A
A1014	Telephone, Wall Mounted, 1 Line, with Speaker	1	A	A	A	A

Room Description: Dental, Porcelain/Ceramic Room, Medium (DNPC2)	NSF: 180	DNPC2	
Sheet Description: Equipment Schedule	Scale:	Sheet 5	of 5