

**Room Description:** Dental, Instrument Decontamination, Medium (DN-SC4)

**NSF:** 120

**DN-SC4**

**Sheet Description:** Room/Equipment Isometric

**Scale:**

Sheet  
**1**

of  
**6**

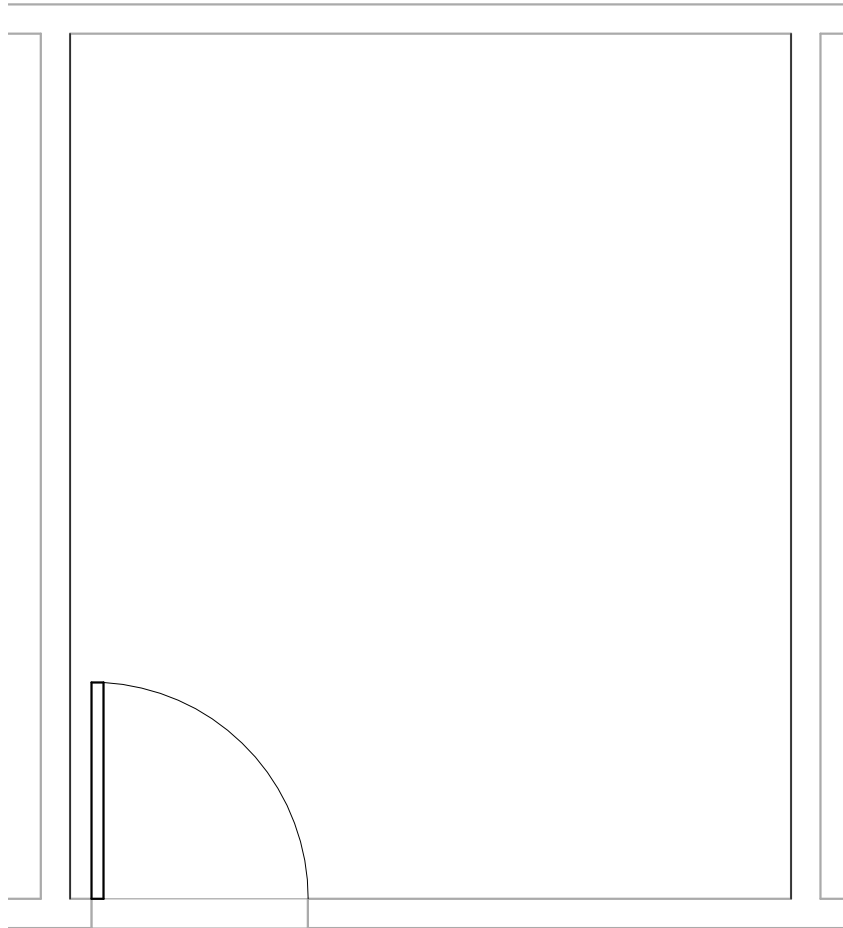

**DNSC4 - CEILING MOUNTED EQUIPMENT PLAN**

<b>Room Description:</b> Dental, Instrument Decontamination, Medium (DNSC4)	<b>NSF:</b> 120	<b>DNSC4</b>	
<b>Sheet Description:</b> Ceiling Mounted Equipment Plan	<b>Scale:</b> 3/8" = 1'-0"	Sheet <b>2</b>	of <b>6</b>

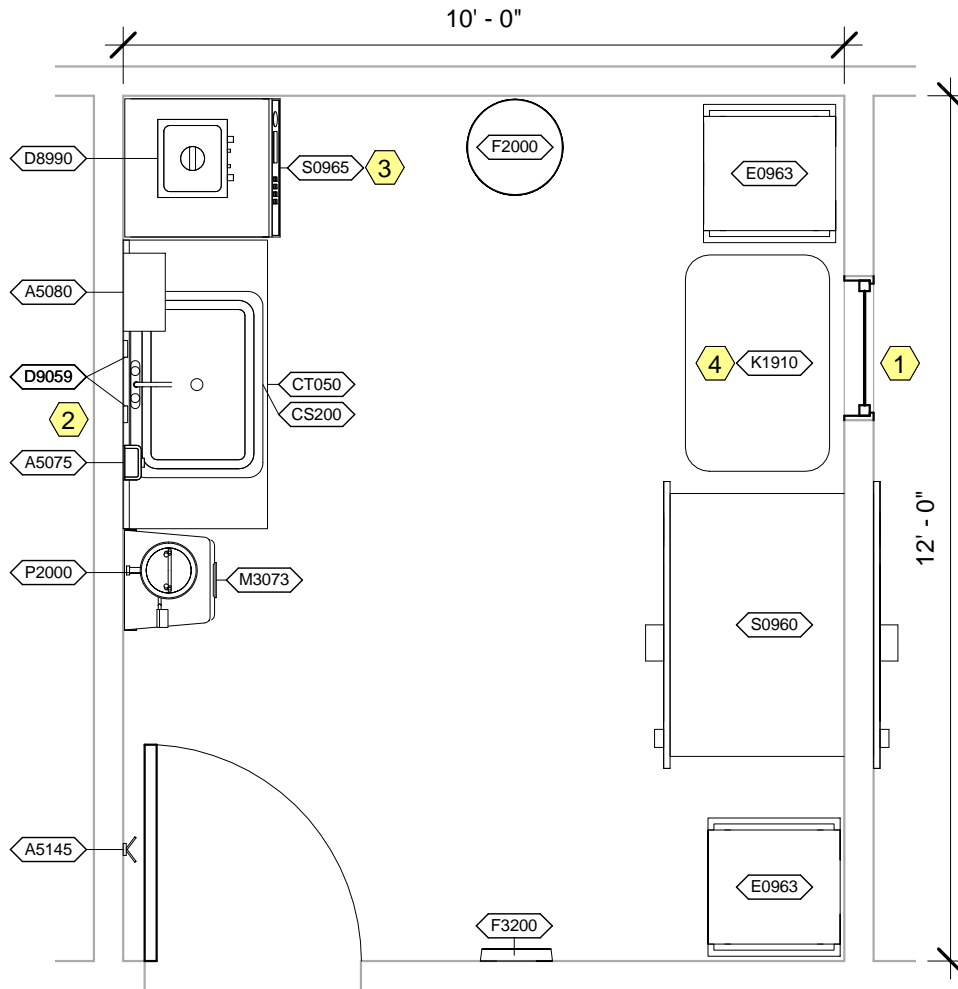

**DNOSC4 - NOTES**

- 1 Pass Window, 24"W x 36"H.
- 2 JSN P8710, Utility Center, shall be included in Navy projects only.
- 3 If JSN S0965, Washer/Disinfector, Dental, does not include a finished top, then extend JSN CT050, Countertop, Stainless Steel, to cover.
- 4 JSN K1910, Table, shall be 36" wide and 24" deep with casters.

<b>Room Description:</b> Dental, Instrument Decontamination, Medium (DNOSC4)	<b>NSF:</b> 120	<b>DNOSC4</b>	
<b>Sheet Description:</b> Equipment Plan	<b>Scale:</b> 3/8" = 1'-0"	Sheet <b>3</b>	of <b>6</b>

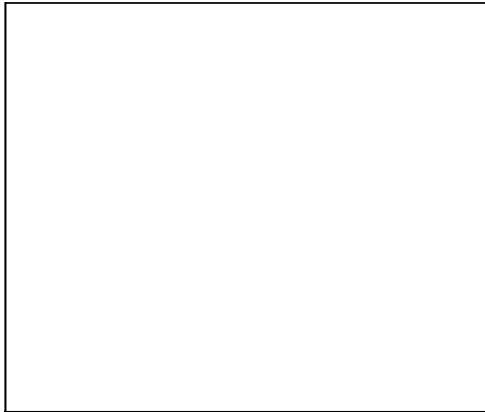

**DNSC4 - NORTH ELEVATION**

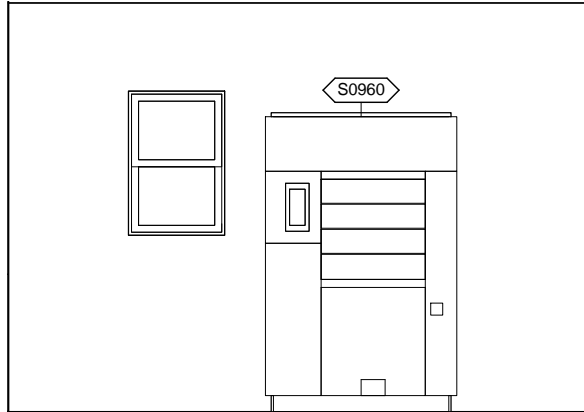

**DNSC4 - EAST ELEVATION**

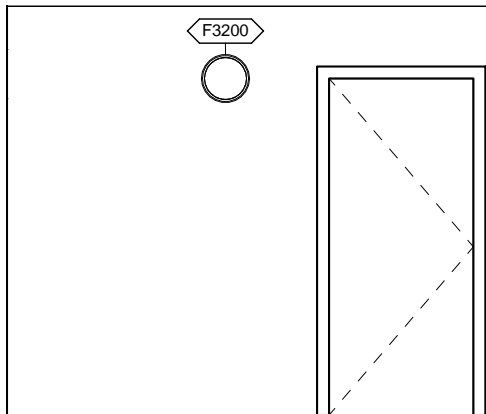

**DNSC4 - SOUTH ELEVATION**

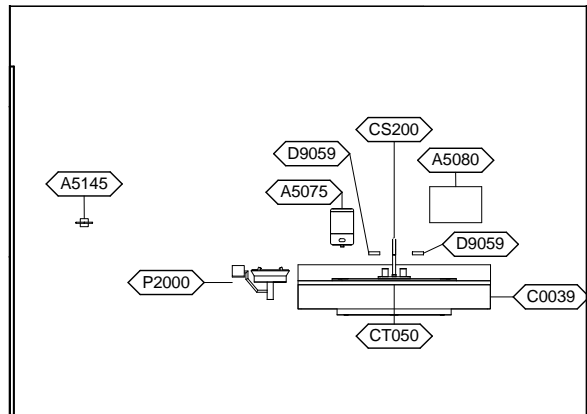

**DNSC4 - WEST ELEVATION**

<b>Room Description:</b> Dental, Instrument Decontamination, Medium (DNSC4)	<b>NSF:</b> 120	<h1>DNSC4</h1>	
<b>Sheet Description:</b> Interior Room Elevations	<b>Scale:</b> 1/4" = 1'-0"	Sheet <h2>4</h2>	of <h2>6</h2>

DNSC4 - EQUIPMENT SCHEDULE

JSN	Nomenclature	Qty	LF	Logistics						Utilities					
				AR	NA	AF	VA	1	2	3	4	5	6		
A5075	Dispenser, Soap, Disposable	1		C	C	C	C	-	-	-	-	-	-	-	
A5080	Dispenser, Paper Towel, SS, Surface Mounted	1		A	A	A	A	-	-	-	-	-	-	-	
A5145	Hook, Garment, Double, SS, Surface Mounted	1		A	A	A	A	-	-	-	-	-	-	-	
C0039	Rail, Apron, 4x48x1	1		A	A	A	A	-	-	-	-	-	-	-	
CS200	Sink, SS, Single Compartment, 12x28x16 ID	1		A	A	A	A	D	-	-	-	-	-	-	
CT050	Countertop, Stainless Steel	1	4'-0"	A	A	A	A	-	-	-	-	-	-	-	
D8990	Cleaner, Ultrasonic, 10-12 Quart Capacity	1		C	C	C	C	-	A	-	-	-	-	-	
D9059	Coupler, Quick Disconnect	2		A	A	A	A	-	-	C	-	-	-	-	
E0963	Cart, General Storage, Mobile	2		C	C	C	C	-	-	-	-	-	-	-	
F2000	Basket, Wastepaper, Round, Metal	1		C	C	C	C	-	-	-	-	-	-	-	
F3200	Clock, Battery, 12" Diameter	1		C	C	C	C	-	-	-	-	-	-	-	
K1910	Table, Work, Stainless Steel	1		A	A	A	A	-	-	-	-	-	-	-	
M3073	Basket, Infectious Waste, Step-On	1		C	C	C	C	-	-	-	-	-	-	-	
P2000	Eyewash, Wall Mounted, Hands-Free	1		A	A	A	A	B	-	-	-	-	-	-	
S0960	Washer/Disinfector,STM,2DO,RCSD1WLL,26X24X24 Cham	1		A	C	C	C	F	G	D	A	-	E	-	
S0965	Washer/Disinfector, Dental	1		A	A	A	A	B	C	-	-	-	-	-	

<b>Room Description:</b> Dental, Instrument Decontamination, Medium (DNSC4)	<b>NSF:</b> 120	<b>DNSC4</b>	
<b>Sheet Description:</b> Equipment Schedule	<b>Scale:</b>	Sheet <b>5</b>	of <b>6</b>

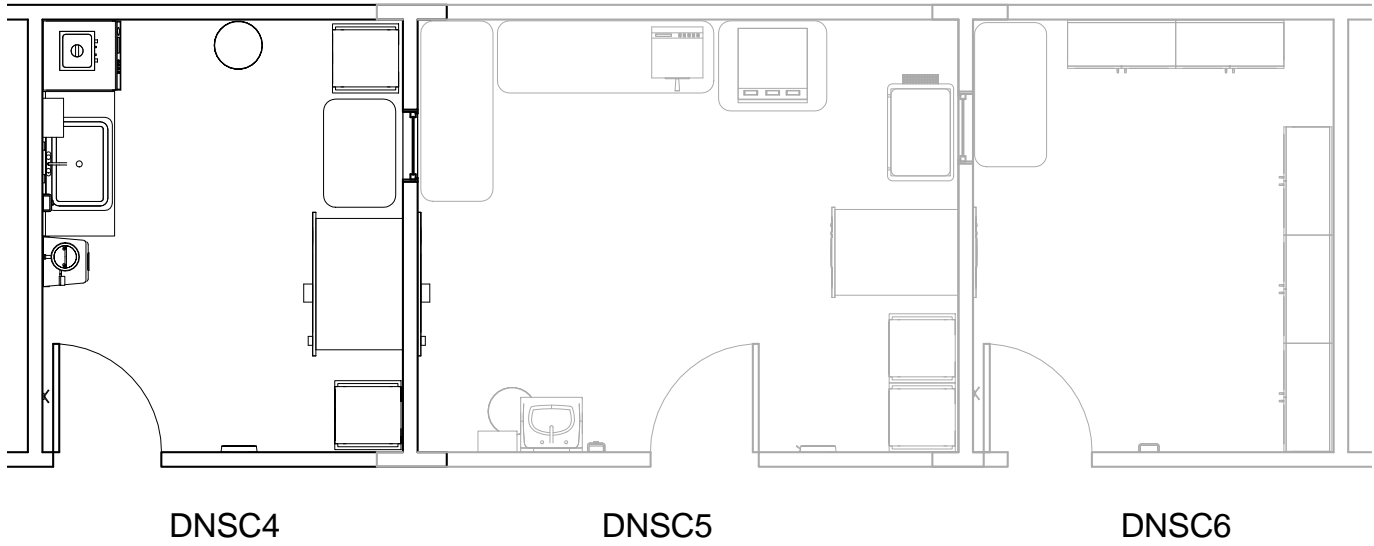

<b>Room Description:</b> Dental, Instrument Decontamination, Medium (DNSC4)	<b>NSF:</b> 120	<h1 style="margin: 0;">DNSC4</h1>	
<b>Sheet Description:</b> Flow Diagram	<b>Scale:</b> 3/16" = 1'-0"	Sheet <h2 style="margin: 0;">6</h2>	of <h2 style="margin: 0;">6</h2>