

NOTES

1. IF DOORS ARE AUTOMATIC, CONNECT TO EQUIPMENT BRANCH POWER.
2. LASER TREATMENTS MAY OCCUR IN THIS ROOM. PROVIDE APPROPRIATE COVERINGS FOR ALL GLAZED OPENINGS. PROVIDE LOW TO NO REFLECTIVE FINISHES ON WALLS, FLOOR, CEILING, DOORS, AND OTHER OPENINGS. PROVIDE APPROPRIATE SIGNAGE AND SIGNAL WARNINGS AT EXTERIOR OF ALL DOORS TO INDICATE WHEN LASER TREATMENTS ARE IN USE/ACTIVATED AND TO INDICATE THE NEED FOR EYE PROTECTION.
3. AN E0954, EMERGENCY CART, AND A M7655, DEFIBRILLATOR, SHALL BE IN THE VICINITY OF THE CYSTOSCOPY W/FLUOROSCOPY ROOM.
4. RECEPTACLES ON CRITICAL POWER SHALL BE SERVED FROM DIFFERENT CRITICAL POWER TRANSFER SWITCHES.

KEY NOTES

1. COORDINATE LOCATION AND QUANTITY OF A1130, NITROGEN CONTROL CABINETS, WITH THE USERS.
2. THESE CHASES ARE PROVIDED FOR THE LOW RETURN AIR. SIZE AND SHAPE MAY VARY.
3. PROVIDE VIEW WINDOW OVER THE SCRUB SINK LOCATION.
4. LENGTH OF E1500, WALL MOUNTED RAIL, TO BE DETERMINED BY MANUFACTURER/INSTALLER.
5. SEE ELEVATION OF A1120, SURGICAL SERVICE COLUMN FOR UTILITIES.
6. DRAIN IS OPTIONAL. IF DRAIN IS USED, INCLUDE A PRIMER OR AN ASPIRATOR TRAP.
7. CONTROL PANEL FOR X6535, RAD/FLUORO/TOMO UNIT.
8. WORKSTATION FOR X6535, RAD/FLUORO/TOMO UNIT.
9. GENERATOR FOR X6536, RAD/FLUORO/TOMO UNIT.
10. MODULAR X-RAY BARRIER.

X-RAY DIAGNOSTIC CYSTOSCOPY  
W/FLUOROSCOPY (XDCY1)

UROLOGY

FLOOR/EQUIPMENT PLAN

40.88 NSM (440 NSF)

DATE: 01/28/2002

0 1000 2000



1:50 SCALE (MILLIMETERS)

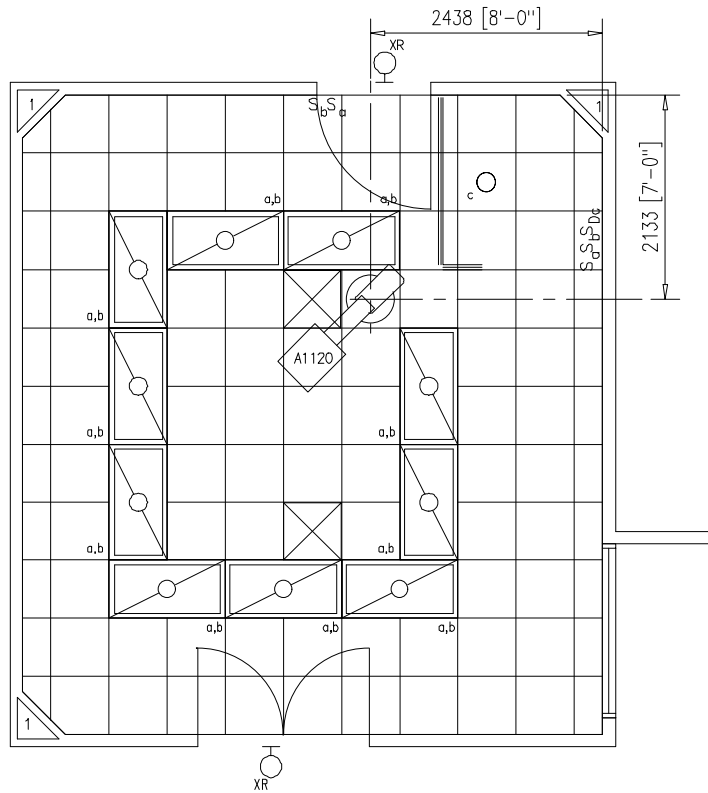

KEY NOTES

1. THESE CHASES ARE PROVIDED FOR THE LOW RETURN AIR. SIZE AND SHAPE MAY VARY.

X-RAY DIAGNOSTIC CYSTOSCOPY  
W/FLUOROSCOPY (XDCY1)

UROLOGY

CEILING PLAN

DATE: 01/28/2002

40.88 NSM (440 NSF)

0 1000 2000



1:50 SCALE (MILLIMETERS)

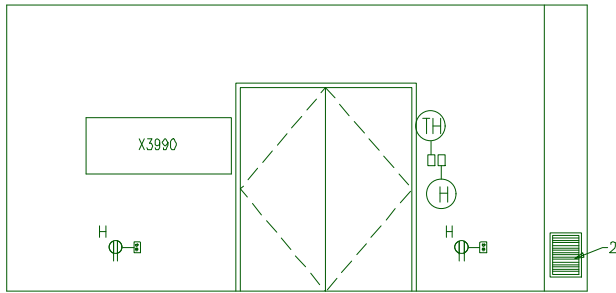

SOUTH

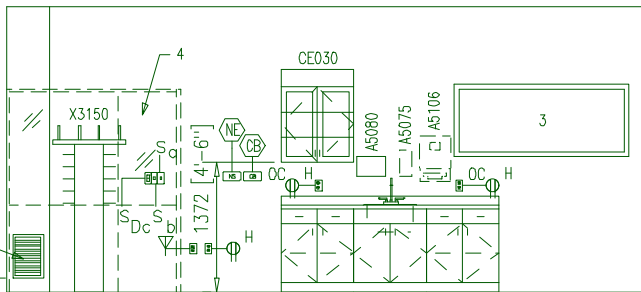

EAST

150 [6"]  
MAXIMUM

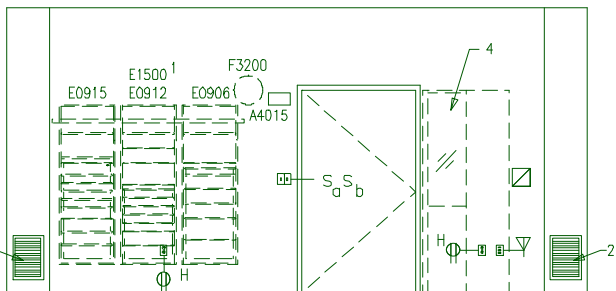

NORTH

KEY NOTES

1. LENGTH OF E1500, WALL MOUNTED RAIL, TO BE DETERMINED BY MANUFACTURER/INSTALLER.
2. LOW RETURN AIR REGISTER.
3. PROVIDE VIEW WINDOW OVER THE SCRUB SINK LOCATION.
4. MODULAR X-RAY BARRIER SHOWN DASHED FOR CLARITY.

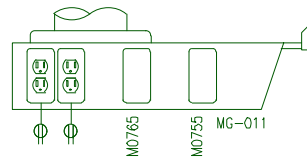

LEFT SIDE

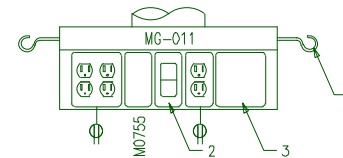

FRONT

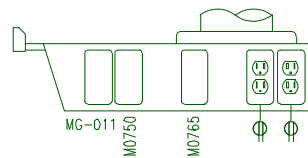

RIGHT SIDE

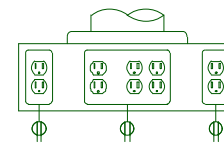

BACK

A1120, PREFAB SURGICAL SERVICE COLUMN.

NOTES

1. GAS OUTLET LOCATIONS ARE FOR REFERENCE ONLY. EXACT CONFIGURATION SHALL BE DETERMINED BY USER.
2. RECEPTACLES IN SURGICAL SERVICE COLUMN SHALL BE HOSPITAL GRADE.

KEY NOTES

1. IV HOOK WITH MOUNT.
2. INTEGRAL UP/DOWN SWITCH.
3. BLANK PROVISION FOR FUTURE DEVICE.

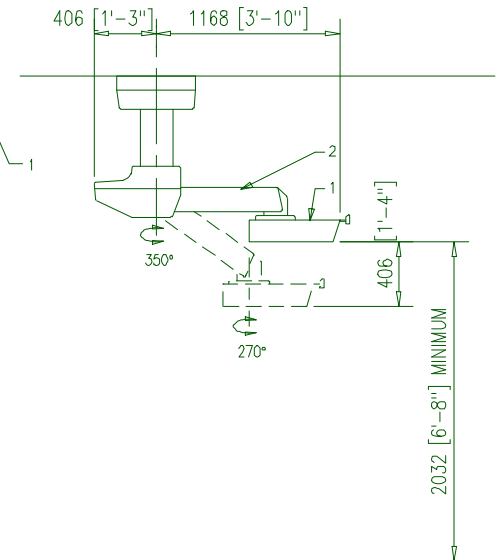
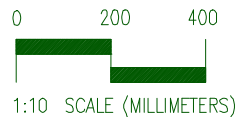

A1120, PREFAB SURGICAL SERVICE COLUMN

KEY NOTES

1. ROTATABLE HEAD.
2. VERTICALLY ADJUSTABLE SUPPORT ARM.

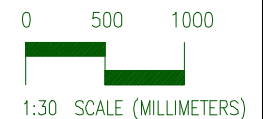

General Notes:

1. For typical equipment mounting heights see "TYPICAL EQUIPMENT MOUNTING HEIGHTS" drawing.
2. MIL-STD-1691 data can only be accessed from the Equipment Plan.

X-RAY DIAGNOSTIC CYSTOSCOPY  
W/FLUOROSCOPY (XDCY1)

UROLOGY

ELEVATIONS

40.88 NSM (440 NSF)

DATE: 01/28/2002

0 1000 2000

1:50 SCALE (MILLIMETERS)

Project Rooms (User Contents Only)

As of 10/04/2005

Page 1

Room Code: XDCY1 Room Qty: 1 Room Area: 440.00 Room Description: XRAY DIAGNOSTIC, CYSTO WITH FLUORO

JSN	NOMENCLATURE	Qty	UNIT	LOG	Utl	Utl	Utl	Utl	Utl	Utl
			ISSUE	CAT	1	2	3	4	5	6

Equipment per Room:

A1120	Column, Service, Prefab, Surgical, Ceiling Mount	1	EA	A	.	F	G	D	.	.
A1130	Cabinet, Control, Nitrogen	1	EA	A	.	B	.	.	.	.
A4015	Clock, Elapsed Time, Electric	1	EA	A	.	A	.	.	.	D
A5075	Dispenser, Soap, Disposable	1	EA	C	.	.	.	.	.	.
A5080	Dispenser, Paper Towel, SS, Surface Mounted	1	EA	A	.	.	.	.	.	.
A5106	Waste Disposal Unit, Sharps w/Glove Dispenser	1	EA	C	.	.	.	.	.	.
C03F0	Cabinet, U/C/B, 1 Shelf, 2 Half DR, 2 DO, 36x30x	2	EA	A	.	.	.	.	.	.
C03P0	Cabinet, Sink, U/C/B, 2 Door, 36x30x22	1	EA	A	.	.	.	.	.	.
CE030	Cabinet, W/H, 2 SH, 2 GDO, Sloping Top, 38x30x13	1	EA	A	.	.	.	.	.	.
CS150	Sink, SS, Single Compartment, 10x19x16 ID	1	EA	A	D	.	.	.	.	.
CT030	Countertop, High Pressure Laminate	8	LF	A	.	.	.	.	.	.
E0703	Table, Process, Adj Height, 5 Drawer, 48"W x 24"	1	EA	C	.	.	.	.	.	.
E0906	Locker, Supply, General, Wall Mtd, 23"W x 20"D	1	EA	C	.	.	.	.	.	.
E0912	Locker, Supply, Med Surg, Wall Mtd	1	EA	C	.	.	.	.	.	.
E0915	Locker, Supply, Medication, Wall Mtd, 23"W x 20"	1	EA	C	.	.	.	.	.	.
E1500	Rail, MOD, W/MNTD, HX144XD	1	EA	C	.	.	.	.	.	.
F0355	Footstool, Straight	1	EA	C	.	.	.	.	.	.
F2000	Basket, Wastepaper, Round, Metal, 18 H x 16 Dia.	1	EA	C	.	.	.	.	.	.
F3200	Clock, Battery, 12" Diameter	1	EA	C	.	.	.	.	.	.
M0630	Anesthesia Apparatus, 3 Gas	1	EA	C	.	A	G	C	.	.
M0750	Flowmeter, Air, Connect w/50 PSI Supply	1	EA	C	.	.	K	.	.	.
M0755	Flowmeter, Oxygen, Low Flow	1	EA	C	.	.	A	.	.	.
M0765	Regulator, Vacuum	3	EA	C	.	.	B	.	.	.
M3070	Hamper, Linen, Mobile, w/Lid	1	EA	C	.	.	.	.	.	.
M3072	Frame, Infectious Waste Bag w/Lid	1	EA	C	.	.	.	.	.	.
M3175	Electrosurgical Unit, Dual Output	1	EA	C	.	A	.	.	.	.
M4116	Monitor, Vital Signs	1	EA	C	.	A	.	.	.	.
M4255	Stand, IV, Adjustable	1	EA	C	.	.	.	.	.	.
M4266	Pump, Volumetric, Infusion, Multiple Line	1	EA	C	.	A	.	.	.	.
M4800	Urodynamic Measurement System w/Video	1	EA	C	.	A	.	.	.	.
M4801	Commode Chair	1	ea	C	.	.	.	.	.	.
M7845	Monitor, Physiological, Bedside, 4 Channel	1	EA	C	.	A	.	.	.	D
M7905	Oximeter, Pulse	1	EA	C	.	A	.	.	.	.

M8551	Light Source, Fiberoptic Headlamp	1	EA	C	.	A	.	.	.	.
M8606	Endoscopy Cart, Fiberoptic, w/Video Accessories	1	EA	C	.	A	.	E	.	.
M8800	Cart, Anesthesia	1	EA	C	.	.	.	.	.	.
M8810	Stand, Mayo	2	EA	C	.	.	.	.	.	.
M8825	Table, Instrument/Dressing, CRS, approx. 36x20x3	1	EA	C	.	.	.	.	.	.
M8830	Table, Instrument/Dressing, Mobile, 34x20x16	1	EA	C	.	.	.	.	.	.
M8900	Carriage, Pail, CRS, Without Pail	1	EA	C	.	.	.	.	.	.
M8905	Pail, Utility, CRS, Without Carriage	1	EA	C	.	.	.	.	.	.
M8910	Cart, Surgical Case	1	EA	C	.	.	.	.	.	.
M8920	Stand, Basin, CRS, Mobile, Double	1	EA	C	.	.	.	.	.	.
M8940	Stool, Anesthesia, With Back	1	EA	C	.	.	.	.	.	.
M8945	Stool, Surgeon, Revolving	1	EA	C	.	.	.	.	.	.
X3150	Rack, Apron/Gloves, Wall Mounted	1	EA	A	.	.	.	.	.	.
X3990	Illuminator, Film, 4 Panels, Wall Mounted	1	EA	C	.	A	.	.	.	.
X6535	Rad/Fluoro/Tomo Unit, Urologic, Digital	1	EA	F	.	F	.	.	.	B

=====

\*\*\*GRAND TOTAL\*\*\*

59