

TREE1 - INTERIOR DESIGN

Floor Finish		Wall Finish		Ceiling Finish		Room Height	Room Noise		
Preferred	Alternate	Preferred	Alternate	Preferred	Alternate	ft - in	Min NC	Max NC	SC
SV	-	GLG	-	GLG	-	9' - 0"	30	35	45

TREE1 - DOOR SCHEDULE

Mark	Type	Count	Height	Width	Notes
			ft - in	ft - in	
C	Single-Flush	1	7' - 0"	4' - 0"	

**Room Description:** Treatment Room, Endoscopy

**NSF:** 240

**TREE1**

**Plate Description:** Room/Equipment Isometric

**Scale:**

Sheet  
**1**

of  
**7**

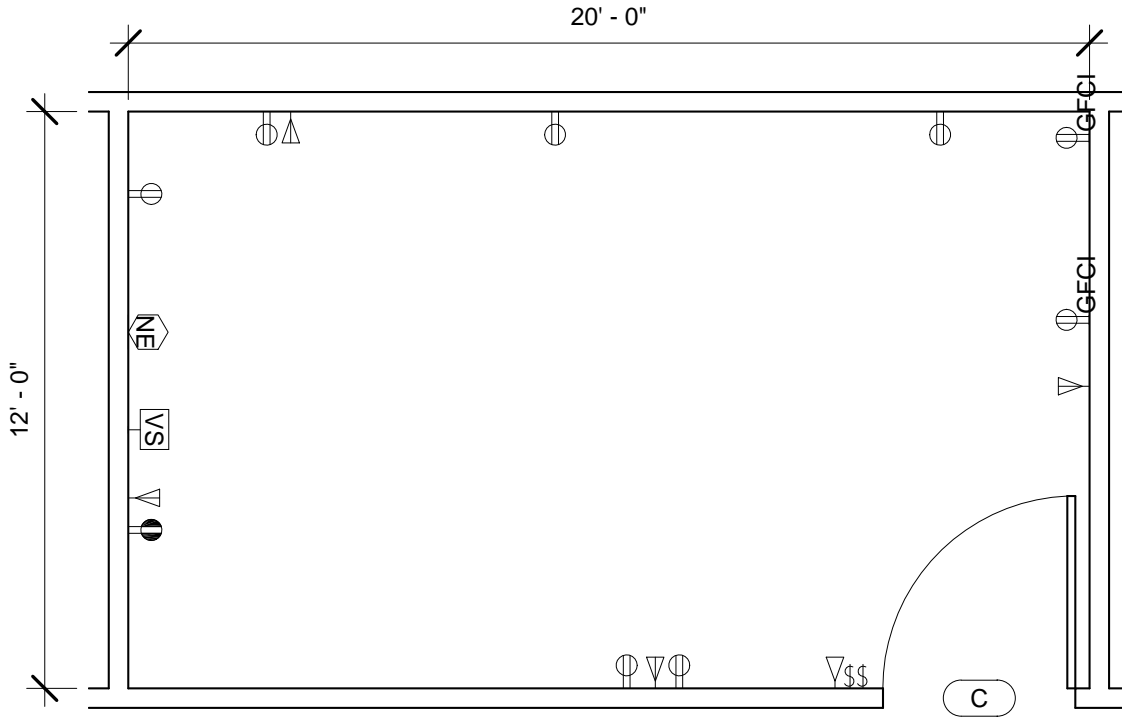

TREE1 - FLOOR PLAN

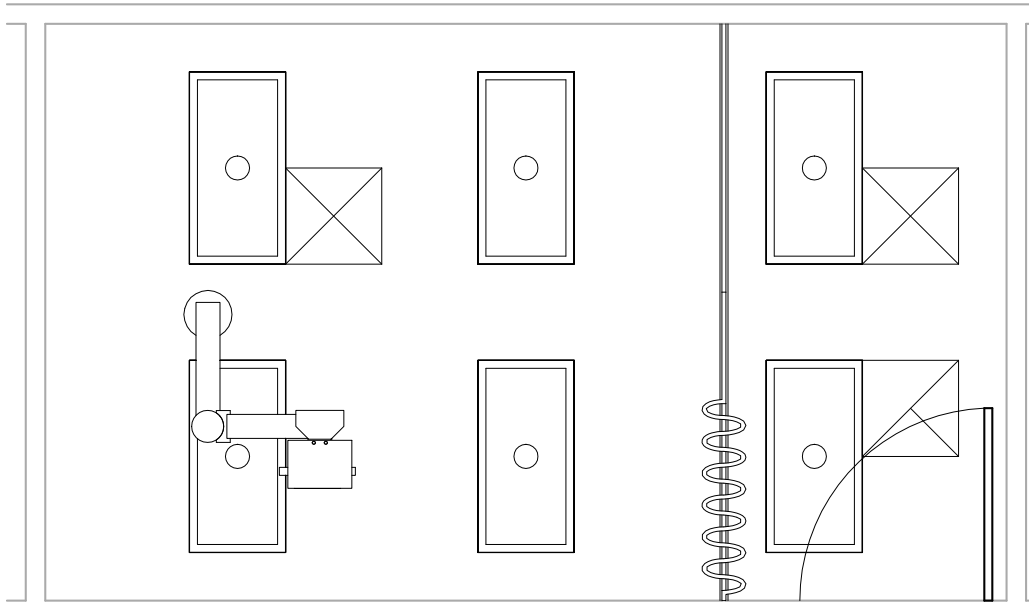

TREE1 - CEILING PLAN

<b>Room Description:</b> Treatment Room, Endoscopy	<b>NSF:</b> 240	<b>TREE1</b>	
<b>Plate Description:</b> Floor & Ceiling Plans	<b>Scale:</b> 1/4" = 1'-0"	Sheet <b>2</b>	of <b>7</b>

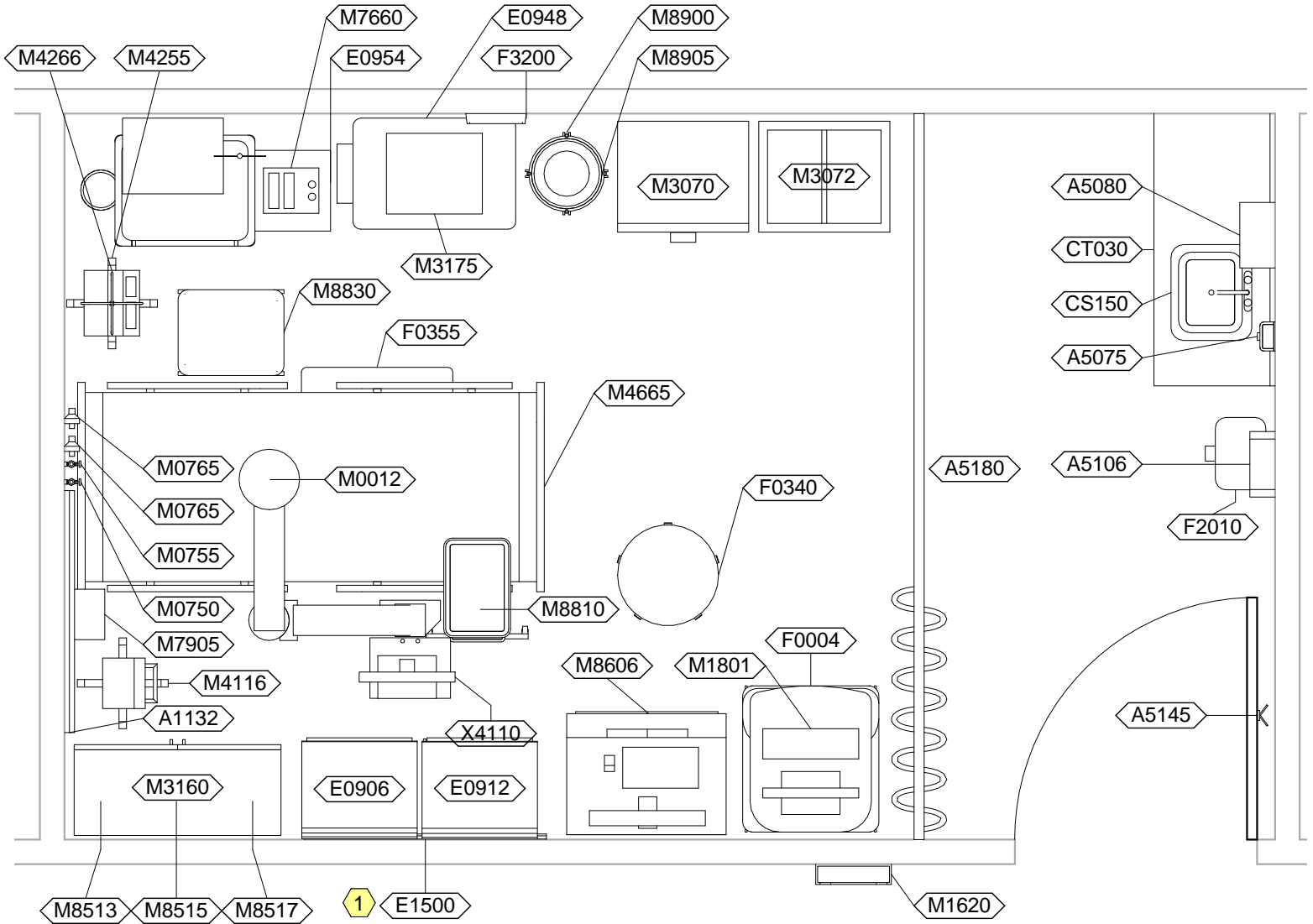

TREE1 - NOTES

- 1 Length of JSN E1500, Rail, Wall Mounted, to be determined by manufacturer/installer.

<b>Room Description:</b> Treatment Room, Endoscopy	<b>NSF:</b> 240	<h1>TREE1</h1>	
<b>Plate Description:</b> Equipment Plan	<b>Scale:</b> 3/8" = 1'-0"	Sheet <h2 style="font-size: 2em;">3</h2>	of <h2 style="font-size: 2em;">7</h2>

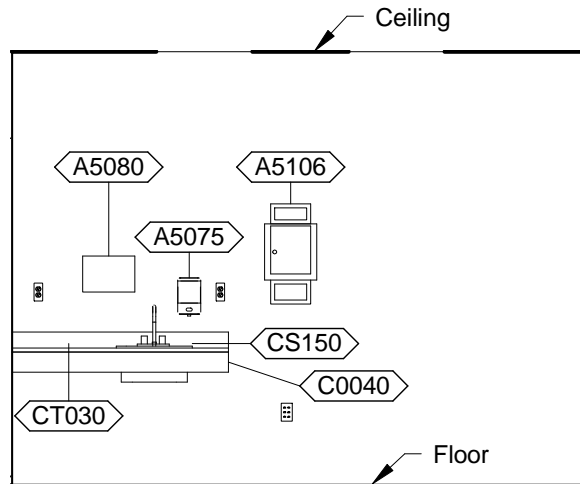

TREE1 - PLAN EAST

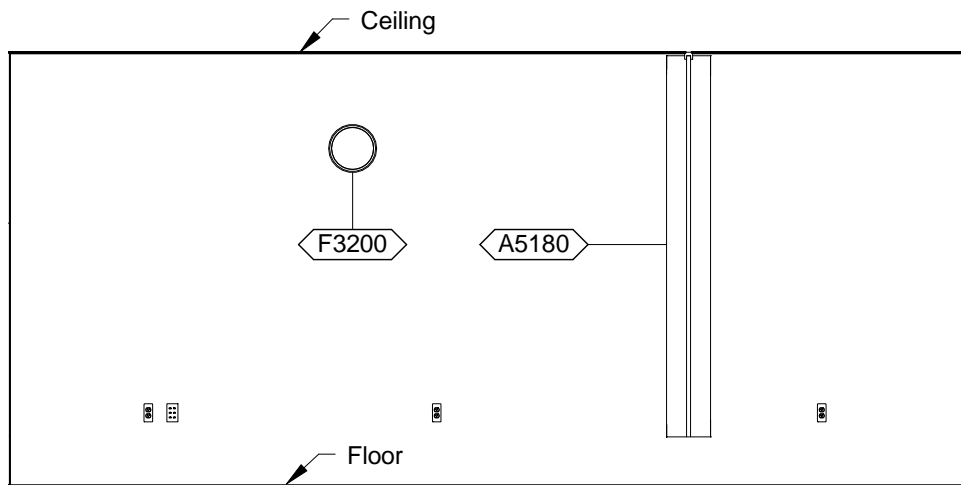

TREE1 - PLAN NORTH

<b>Room Description:</b> Treatment Room, Endoscopy	<b>NSF:</b> 240	<h1>TREE1</h1>	
<b>Plate Description:</b> Interior Room Elevations	<b>Scale:</b> 1/4" = 1'-0"	Sheet <h2>4</h2>	of <h2>7</h2>

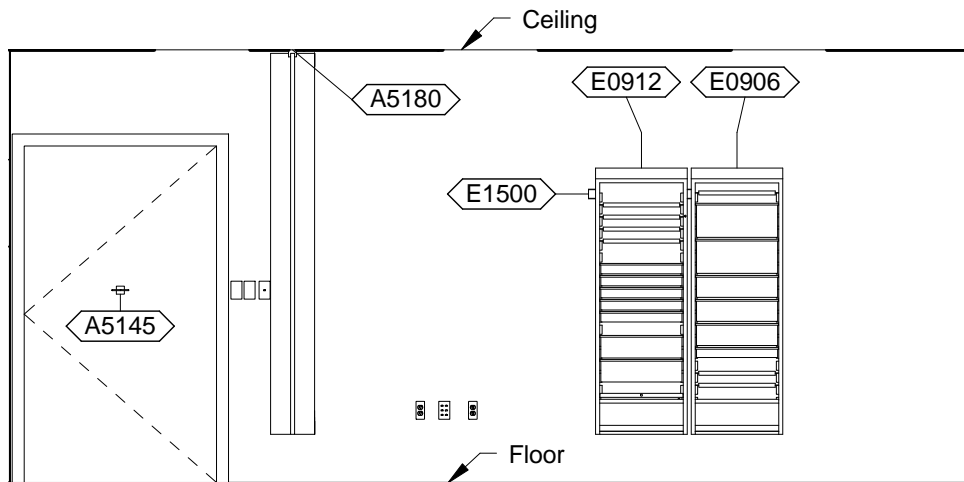

**TREE1 - PLAN SOUTH**

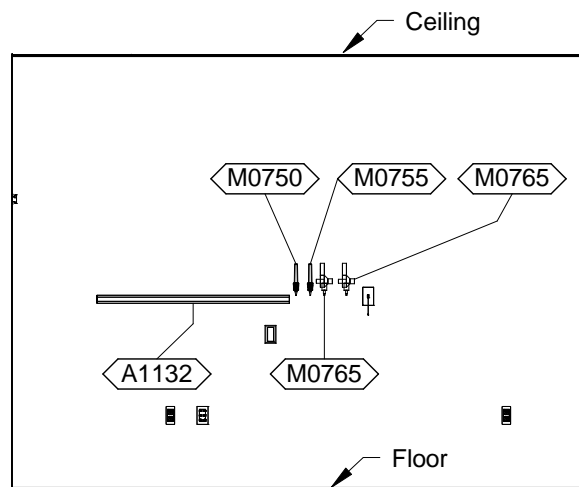

**TREE1 - PLAN WEST**

<b>Room Description:</b> Treatment Room, Endoscopy	<b>NSF:</b> 240	<b>TREE1</b>	
<b>Plate Description:</b> Interior Room Elevations	<b>Scale:</b> 1/4" = 1'-0"	Sheet <b>5</b>	of <b>7</b>

TREE1 - EQUIPMENT SCHEDULE

JSN	Nomenclature	Qty	Logistics				Utilities					
			AR	NA	AF	VA	1	2	3	4	5	6
A1132	Rail, Accessory Mounting, 48"	1	A	A	A	A	-	-	-	-	-	-
A5075	Dispenser, Soap, Disposable	1	C	C	C	C	-	-	-	-	-	-
A5080	Dispenser, Paper Towel, SS, Surface Mounted	1	A	A	A	A	-	-	-	-	-	-
A5106	Waste Disposal Unit, Sharps w/Glove Dispenser	1	C	A	C	C	-	-	-	-	-	-
A5145	Hook, Garment, Double, SS, Surface Mounted	1	A	A	A	A	-	-	-	-	-	-
A5180	Track, Cubicle, Surface Mounted, With Curtain	1	A	A	A	A	-	-	-	-	-	-
C0040	Rail, Apron, 4x54x1	2	A	A	A	A	-	-	-	-	-	-
CS150	Sink, SS, Single Compartment, 10x19x16 ID	1	A	A	A	A	D	-	-	-	-	-
CT030	Countertop, High Pressure Laminate	1	A	A	A	A	-	-	-	-	-	-
E0906	Locker, Supply, General, Wall Mtd, 23"W x 20"D	1	C	C	C	C	-	-	-	-	-	-
E0912	Locker, Supply, Med Surg, Wall Mtd	1	C	C	C	C	-	-	-	-	-	-
E0948	Cart, General Storage, Mobile, 42"H x 32"W x 22"D	1	C	C	C	C	-	-	-	-	-	-
E0954	Cart, Emergency, Mobile, 66"H x 52"W x 22"D	1	C	C	C	C	-	-	-	-	-	-
E1500	Rail, MOD, W/MNTD, HX144XD	1	C	C	C	F	-	-	-	-	-	-
F0004	Mobile, Workstation	1	-	-	-	-	-	-	-	-	-	-
F0340	Stool, Self Adjusting	1	C	C	C	C	-	-	-	-	-	-
F0355	Footstool, Straight	1	C	C	C	C	-	-	-	-	-	-
F2010	Basket, Wastepaper, Step-On	1	C	C	C	C	-	-	-	-	-	-
F3200	Clock, Battery, 12" Diameter	1	C	C	C	C	-	-	-	-	-	-
M0012	Service Column, Endoscopy	1	-	-	-	-	-	-	-	-	-	-
M0750	Flowmeter, Air, Connect w/50 PSI Supply	1	C	C	C	C	-	-	K	-	-	-
M0755	Flowmeter, Oxygen, Low Flow	1	C	C	C	C	-	-	A	-	-	-
M0765	Regulator, Vacuum	2	C	C	C	C	-	-	B	-	-	-
M1620	Holder, Chart, Patient, Wall or Door Mounted	1	A	A	A	A	-	-	-	-	-	-
M1801	Computer, Microprocessing, w/Flat Panel Monitor	1	C	C	C	C	-	A	-	-	-	-
M3070	Hamper, Linen, Mobile, w/Lid	1	C	C	C	C	-	-	-	-	-	-
M3072	Frame, Infectious Waste Bag w/Lid	1	C	C	C	C	-	-	-	-	-	-
M3160	Cabinet, Storage, Hanging Scopes	1	C	C	C	C	-	-	-	-	-	-
M3175	Electrosurgical Unit, Dual Output	1	C	C	C	C	-	A	-	-	-	-
M4116	Monitor, Vital Signs	1	C	C	C	C	-	A	-	-	-	-
M4255	Stand, IV, Adjustable	1	C	C	C	C	-	-	-	-	-	-
M4266	Pump, Volumetric, Infusion, Multiple Line	1	C	C	C	C	-	A	-	-	-	-
M4665	Stretcher, Recovery, Surgical	1	C	C	C	C	-	-	-	-	-	-
M7660	Defibrillator/Monitor/Recorder, Portable	1	C	C	C	C	-	A	-	-	-	-
M7905	Oximeter, Pulse	1	C	C	C	C	-	A	-	-	-	-
M8513	Duodenoscope, Fiberoptic, Therapeutic	1	C	C	C	C	-	-	-	-	-	-
M8515	Gastroscope, Fiberoptic, Therapeutic	1	C	C	C	C	-	-	-	-	-	-
M8517	Enteroscope, Fiberoptic, Therapeutic	1	C	C	C	C	-	-	-	-	-	-
M8606	Endoscopy Cart, Fiberoptic, w/Video Accessories	1	C	C	C	C	-	A	-	E	-	-
M8810	Stand, Mayo	1	C	C	C	C	-	-	-	-	-	-
M8830	Table, Instrument/Dressing, Mobile	1	C	C	C	C	-	-	-	-	-	-
M8900	Carriage, Pail, CRS, Without Pail	1	C	C	C	C	-	-	-	-	-	-
M8905	Pail, Utility, CRS, Without Carriage	1	C	C	C	C	-	-	-	-	-	-
X4110	Console, PACS, Remote View, 512 X 512, 1 Monitor	1	F	F	F	F	-	B	-	-	-	-

<b>Room Description:</b> Treatment Room, Endoscopy	<b>NSF:</b> 240	<b>TREE1</b>	
<b>Plate Description:</b> Equipment Schedule	<b>Scale:</b>	Sheet <b>6</b>	of <b>7</b>

**TREE1 - DATA/TELEPHONE EQUIPMENT**

JSN	Nomenclature	Qty	Logistics			
			AR	NA	AF	VA
A1010	Telecommunication Outlet	4	A	A	A	A
A1015	Telephone, Desk, Multiple Line	1	A	A	A	A

<b>Room Description:</b> Treatment Room, Endoscopy	<b>NSF:</b> 240	<b>TREE1</b>	
<b>Plate Description:</b> Equipment Schedule	<b>Scale:</b>	Sheet <b>7</b>	of <b>7</b>